

GOSHEN TWP 00130 Hardin County, Ohio Michael T. Bacon, Auditor 14-030012.0000 RES 2025 KENTON SD A35

sale

Table with columns for year (2022-2025), name (PFEIFFER JAY E & LYND, LEE PHILLIP A & KELLI), address (7817 CR 205), and value (\$0).

Table with columns for Eff Rate (51.44, 44.77, 47.15, 46.85), Tax Year (2022-2025), Prop Cls, Acres, Land100%, Bldg100%, Totl100%, Cauvl00%, Tax Value, and Sp-Asmnt.

Table with columns for SHB+, CONS, TYPE, FACT, SQ-FT, VALUE, and other details for various lots.

Table with columns for Sale#, #p, sale date, To, Type/Invalid?, Sales\$, co:land, and co:blgd.

Table with columns for Year, Land, Bldg, Total, and Net Tax for years 2021 and 2020.

Table with columns for project name (FEWELL, HARDIN COUNTY LANDFILL, PFEIFFER DITCH TYMOCHTEE CRE), ben acres, and % factor.

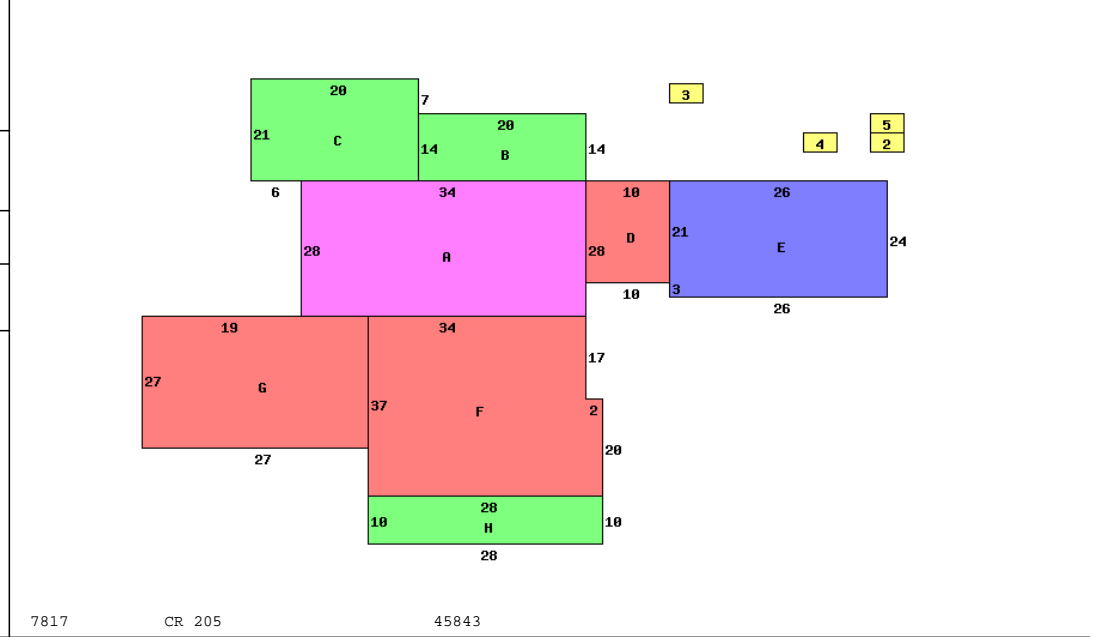

Table with columns for Occupancy (1 Single Family), \*DWELLING COMPUTATIONS (Sq-Ft, Value), and various building details like Story Height, Floor Level, Shingle, etc.

Table with columns for Bldg Type, SHB+Cons, DixHt, Area, Unit Rate, Grade, Blt/Renov, Replace, Phy Fnc, True Value, and other building specifications.