

DUDLEY TWP
RIDGEMONT SD

00110

Hardin County, Ohio
Michael T. Bacon, Auditor

12-100010.0000
C137

AGR
2025

sale

Eff Rate:- 48.25 — 41.25 — 43.62 — 43.11 — a/r

2022 SMITH JAMES E & YEVON	2018-01-05				
2023 SMITH JAMES E & YEVON	2018-01-05				
2024 SMITH JAMES E & YEVON	2018-01-05				
2025 SMITH JAMES E & YEVONNE	2018-01-05	12115 13279 13325 15379			
17377 TR 195	2SD	132.471A			
KENTON OH 43326	\$0				

Tax Year	2022	2023	2024	2025	CAMA
Prop Cls	111	111	111	111	111
Acres	132.4710	132.4710	132.4710	132.4710	
Land100%	578510	633430	633430	633430	633440
Bldg100%	260710	317770	317770	317770	317780
Totl100%	839230t	951200t	951200t	951200t	951220t
Cauv100%	112740	247200	247200	247200	247190
Tax Value:					
Land 35%	39460	86520	86520	86520	221700
Bldg 35%	91250	111220	111220	111220	111220
Totl 35%	130710t	197740t	197740t	197740t	332930t
Hmstd35%	80780	96200	96200	96200	
Owner Oc	84.70	84.82	84.74	84.38	hmstd 5250 l 90950 b
Hmstd RB					
Net Tax	5673.74	7374.54	7843.34	7746.48	
Cauv Sav	7181.84	5099.40	5419.84	5353.34	
Sp-Asmnt	47.60	66.83	63.51	101.96	

SHB+	CONS	TYPE	FACT	SQ-FT	VALUE	a	*MAIN
1 B	B	M		2208			
	PAT	P		336	1010	b	PORCH
	BAL	P		480	7200	c	PORCH
	PAT	P		480	1440	d	PORCH
	E2	G		900	25200	e	GRAGE
	OFFP	P		240	7200	f	PORCH
	OFFP	P		36	1080	g	PORCH

#: 11-12,14,60-61,69, L/W

121000110000	20.60a
121000120000	30.617a
121000140000	37.991a
121000600000	.807a
121000610000	.217a
121000690000	5.333a

Sale#	#p	sale date	To	Type/Invalid?	Sale\$	co:land	co:blgd
5	2	2018-01-05	SMITH JAMES E & YEVONNE L	2SD *	0	583310	194510
70	1	1993-02-01	SMITH JAMES E & MOTTER Y	LWD *	43500	0	29510
278	1	1989-04-12		LWD *	50000	0	59230
276	1	1989-04-12		LUN *	0	0	59230
782	1	1988-09-20		LUN *	0	0	59230

Year	Land	Bldg	Total	Net Tax
2021	39460	82740	122200	5405.10
2020	39460	82740	122200	5412.46

Project
902 MAIN DISTRICT CONSERVANCY
500 HARDIN COUNTY LANDFILL
348 KARG-SCIOTO RIVER

ben acres / % factor
XA/2025
XA/2025
XA/2025

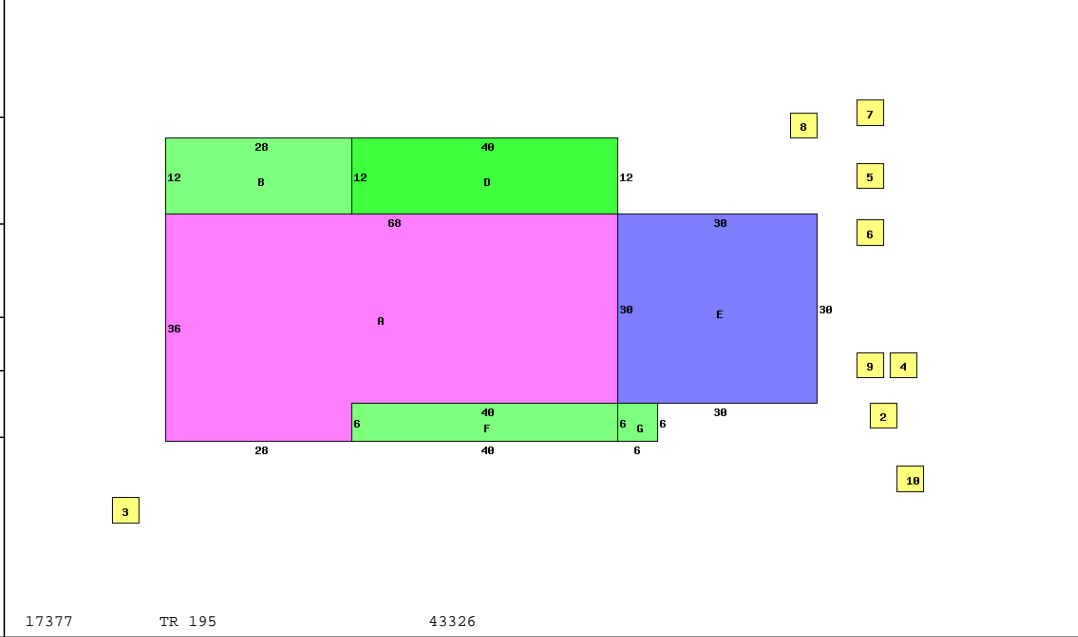

17377 TR 195 43326

Occupancy	1 Single Family	*DWELLING COMPUTATIONS
Story Height	1	Sq-Ft Value
Floor Level	Main BRICK	2208 162620
	Basement	2208 40690
	Subtotal	203310
Metal Roof	GABLE	
B 1 2 U A		
Plaster/Drywall	D	Air Conditioning 3860
Unfinished Wall	X	Plumbing 4200
Floor/Carpet	X	Garages and Carports 25200
Floor/Concrete	X	Extra Features 17930
Number of Rooms	3 6	Total Value 254500
Bedrooms	3	
Central Heat	A	PUB ELECTRIC
FORCED AIR		PRIV WATER
Central A/C	A	PRIV SEWER
Plumbing		PUB PAVED ST/RD
Standard	1	Topo: ROLLING
Extra 3 Fixture	2	Neighborhood:
		Code: 1000
		Dwl/Gar/NC% 1.1900

Bldg Type	SHB+Cons	DixHt	Area	Unit Rate	Grade	Blt/Renov Cond	Replace Value	Phy Dpr	Fnc Dpr	True Value
1 DWELLING	1 B B	2208			C+	1994GD	279950	.22		259850
2 Pole Build	1 P 0	36X60	2160		C	1993AV	25920	.60		10370
3 POND	*.20A		0			OLD/	0			0
4 Shed		12X20	240		D	1995AV	2300	.60		920
5 Shed			320		D	1996AV	3070	.60		1230
6 Shed		10X20	200		D	2003AV	1920	.50		960
7 Shed		12X20	240		D	2000AV	2300	.55		1040
8 Shed		24X60	1440		D	1995AV	13820	.60		5530
9 Shed		14X26	364		D	1995AV	3490	.60		1400
10 Pole Build		40X80	3200		C	2022AV	38400	.05		36480

Tab #	S O I L	Acres	Mkt/Ac	Market	Au/Ac	Cauv
C 1	BOA BLOUNT SILT LOAM 0-	12.3376	6030	74400	2660	32820
C 2	BOB BLOUNT SILT LOAM, 2	14.2304	5770	82110	2360	33580
C 8	EE EEL SILT LOAM, OCCA	7.0933	5550	39370	2460	17450
C 14	GWB GLYNWOOD SILT LOAM	11.4711	5400	61940	1750	20070
C 15	GYB2 GLYNWOOD CLAY LOAM	3.6604	5020	18380	1230	4500
C 16	GYC2 GLYNWOOD CLAY LOAM	2.5057	4750	11900	1050	2630
C 33	NE NEWARK SILT LOAM OC	2.1748	5800	12610	2280	4960
C 39	PM PEWAMO SILTY CLAY L	8.6244	6490	55970	3560	30700
C 46	SKA SLEETH SILT LOAM, 0	7.0753	5880	41600	2970	21010
C 47	SO SLOAN SILT LOAM, FR	6.0801	6490	39460	2920	17750
W 1	BOA BLOUNT SILT LOAM 0-	3.7926	3610	13690	770	2920
W 2	BOB BLOUNT SILT LOAM, 2	7.8336	3130	24520	470	3680
W 8	EE EEL SILT LOAM, OCCA	11.7950	3990	47060	1460	17220
W 14	GWB GLYNWOOD SILT LOAM	15.4071	2830	43600	750	11560
W 15	GYB2 GLYNWOOD CLAY LOAM	.8409	1830	1540	230	190
W 16	GYC2 GLYNWOOD CLAY LOAM	3.6349	1460	5310	230	840
W 33	NE NEWARK SILT LOAM OC	6.1727	2900	17900	390	2410
W 36	OCB OCKLEY LOAM, 2-6% S	2.1263	3960	8420	1350	2870
W 39	PM PEWAMO SILTY CLAY L	1.7982	5370	9660	1670	3000
W 46	SKA SLEETH SILT LOAM, 0	.0309	4230	130	1080	30
W 47	SO SLOAN SILT LOAM, FR	1.9445	4560	8870	1030	2000
W 670	HSITE HOMESITE	1.0000	15000	15000		15000