

DUDLEY TWP 00100 Hardin County, Ohio Michael T. Bacon, Auditor 10-360038.0000 RES 2025 KENTON SD

sale Eff Rate:- 50.85 45.71 48.08 47.49 a/r

Table with columns: Year, Sale#, Sale Date, To, Type/Invalid?, Sale\$, co:land, co:blgd. Includes rows for 2022, 2023, 2024, and 2025 sales.

Table with columns: Tax Year, Prop Cls, Acres, Land100%, Bldg100%, Totl100%, Cauv100%, Tax Value, Land 35%, Bldg 35%, Totl 35%, Hmstd35%, Owner Oc, Hmstd RB, Net Tax, Sp-Asmnt.

Table with columns: SHB+, CONS, TYPE, FACT, SQ-FT, VALUE. Includes rows for 1, DK, OFF.

#: 36,37,39 L/W 00MBINED PARCELS FOR 2014 DUPLICATE 103600360000 103600370000 103600390000

Table with columns: Year, Land, Bldg, Total, Net Tax. Includes rows for 2021 and 2020.

Table with columns: Project, ben acres, % factor. Includes rows for 902 MAIN DISTRICT CONSERVANCY, 500 HARDIN COUNTY LANDFILL, 145 HEPBURN - SCIOTO RIVER.

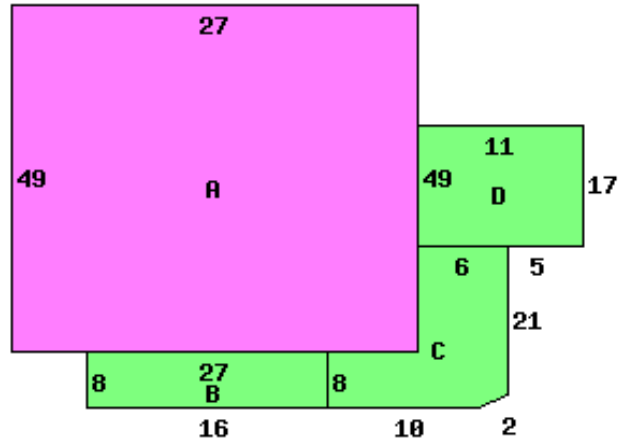

13572 WEST ST 43326

Table with columns: Occupancy, *DWELLING COMPUTATIONS, Sq-Ft, Value. Includes rows for Story Height, Floor Level, Shingle, Roof, and various fixtures.

Table with columns: Bldg Type, SHB+Cons, DixHt, Area, Unit Rate, Grade, Blt/Renov, Cond, Replace Value, Phy Dpr, Fnc Dpr, True Value. Includes rows for 1 MH/REAL and 2 Garage.

Table with columns: front lot, acres/frontage, effective frontage, depth, depth factor, actual rate, effective rate, extended value, true value. Includes a row for front lot with values 200.00, 150, 100, 50, 50, 10000, 6500, Excess Fro.