

DUDLEY TWP 00100 Hardin County, Ohio Michael T. Bacon, Auditor 10-310010.0000 AGR 2025 KENTON SD

sale

Eff Rate:- 50.85 45.71 48.08 47.49 a/r

Table with columns for year, owner name, and address. Includes entries for 2022-2025 WRIGHT SAMUEL JR & RH and 2025 WRIGHT SAMUEL JR & RHON.

Table with columns for Tax Year (2022-2025), Prop Cls, Acres, Land/Building values, and Tax Value breakdown (Land, Bldg, Totl, Hmstd, Owner, Hmstd RB, Net Tax, Cauv Sav, Sp-Asmnt).

Table with columns for SHB+, CONS, TYPE, FACT, SQ-FT, VALUE, a, \*MAIN, b, PORCH. Includes project details for 902 MAIN DISTRICT CONSERVANCY and 500 HARDIN COUNTY LANDFILL.

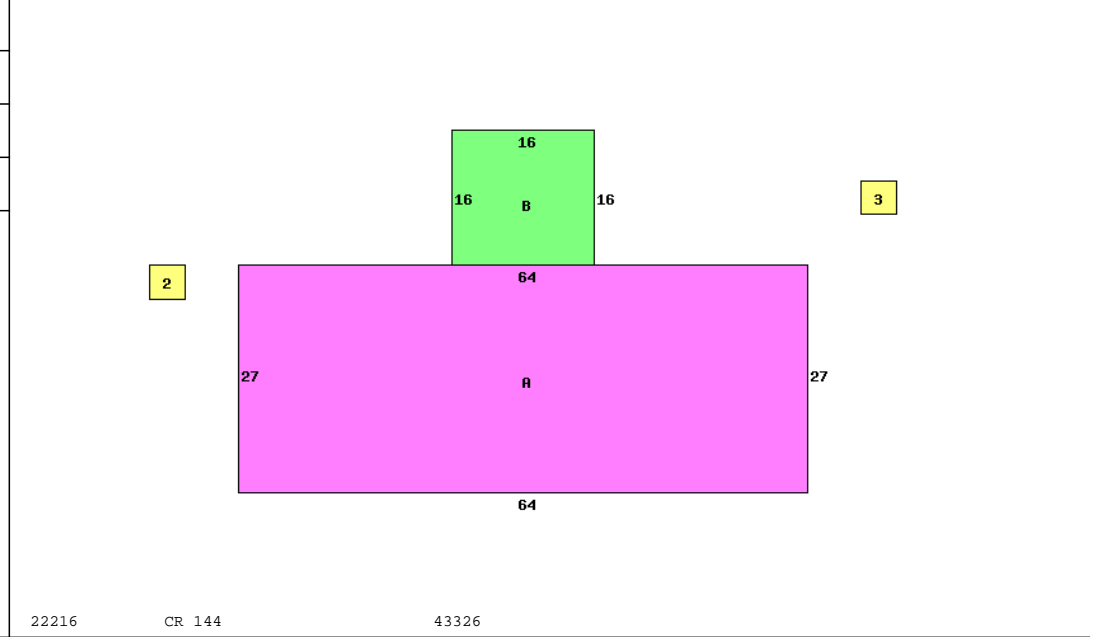

Table with columns for Occupancy, Dwelling Computations (Sq-Ft, Value), and various building features like Story Height, Floor Level, Shingle, Plaster/Drywall, etc.

Table with columns for Bldg Type, SHB+Cons, DixHt, Area, Unit Rate, Grade, Blt/Renov, Replace, Phy Fnc, True Value. Includes a list of items with descriptions and values.