

DUDLEY TWP 00100 Hardin County, Ohio Michael T. Bacon, Auditor 10-300007.0000 K41 AGR 2025

sale

Eff Rate:- 50.85 45.71 48.08 47.49 a/r

Table with columns for year (2022-2025), owner name (BORNTREGER ERVIN & AD), address (21821 CR 144), and value (\$0).

Table with columns for Tax Year (2022-2025), Prop Cls, Acres, Land100%, Bldg100%, Totl100%, and Tax Value (Land 35%, Bldg 35%, etc.).

Table with columns for SHB+, CONS, TYPE, FACT, SQ-FT, VALUE, and various codes (a-j).

Table with columns for Sale#, #p, sale date, To, Type/Invalid?, Sale\$, co:land, co:blgd.

Table with columns for Year, Land, Bldg, Total, Net Tax.

Table with columns for project name (902 MAIN DISTRICT CONSERVANCY), location (500 HARDIN COUNTY LANDFILL), and dates (XA/2025).

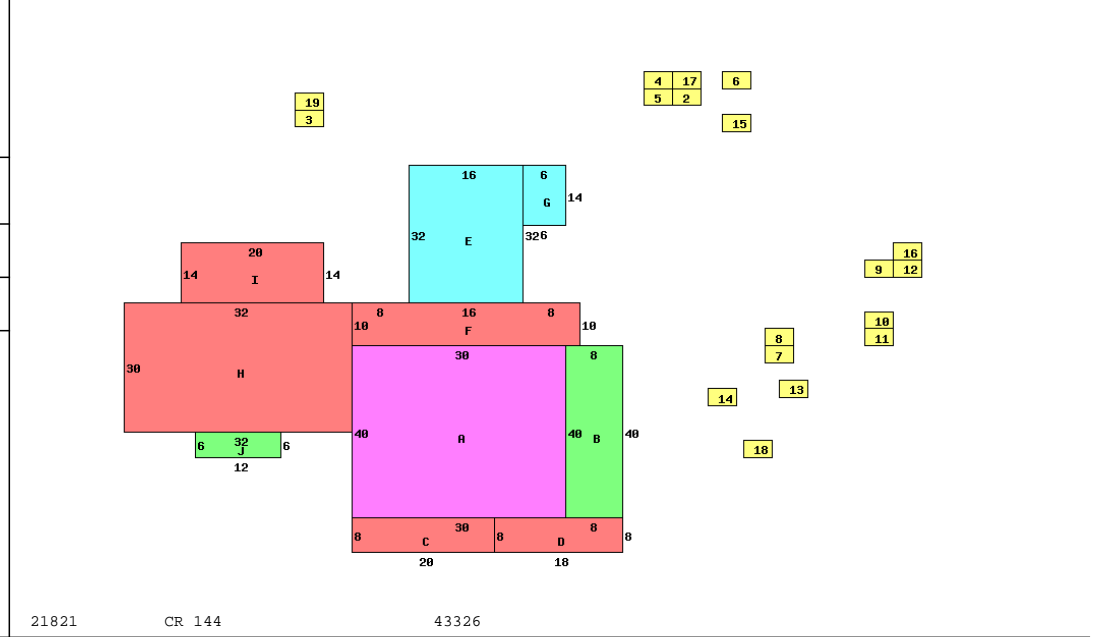

Table with columns for Occupancy (1 Single Family), \*DWELLING COMPUTATIONS (Sq-Ft, Value), and other details like Story Height, Floor Level, Shingle, etc.

Table with columns for Bldg Type, SHB+Cons, DixHt, Area, Unit Rate, Grade, Blt/Renov, Replace, Phy, Fnc, True Value.

Table with columns for Tab #, S O I L, Acres, Mkt/Ac, Market, Au/Ac, and Cauv.