

DUDLEY TWP KENTON SD 00100 Hardin County, Ohio Michael T. Bacon, Auditor 10-291019.0000 RES 2025 L23

sale

Eff Rate:- 50.85 45.71 48.08 47.49 a/r

Table with columns: Year, Sale#, #p, sale date, To, Type/Invalid?, Sale\$, co:land, co:bldg. Includes entries for 2022-2025 KINDELL DOUGLAS W & H and STOCKFISCH R G TRUSTEE.

Table with columns: Tax Year, Prop Cls, Acres, Land100%, Bldg100%, Totl100%, Cauvl00%, Tax Value, Land 35%, Bldg 35%, Totl 35%, Hmstd35%, Owner Oc, Hmstd RB, Net Tax, Sp-Asmnt. Includes tax details for years 2022-2025.

Table with columns: Year, Sale#, #p, sale date, To, Type/Invalid?, Sale\$, co:land, co:bldg. Includes entry for 2026 PETITT ARTHUR A.

Table with columns: SHB+, CONS, TYPE, FACT, SQ-FT, VALUE, a, *MAIN, b, ADDTN, c, PORCH, d, ADDTN. Includes details for lots 1 and 1.

Table with columns: Sale#, #p, sale date, To, Type/Invalid?, Sale\$, co:land, co:bldg. Includes historical sales from 2009 to 2019.

Table with columns: Year, Land, Bldg, Total, Net Tax. Includes summary for years 2021 and 2020.

Table with columns: Project, ben acres, % factor. Includes project details for MAIN DISTRICT CONSERVANCY, HARDIN COUNTY LANDFILL, and ELDRIDGE SEWER.

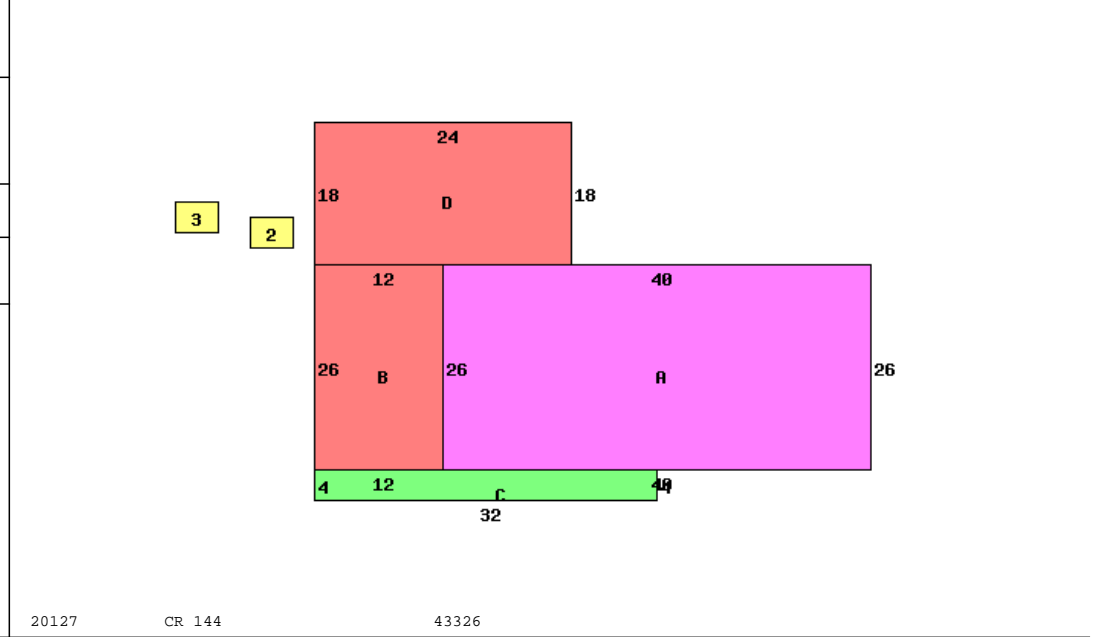

Table with columns: Occupancy, *DWELLING COMPUTATIONS, Sq-Ft, Value. Includes details for Single Family occupancy and dwelling features like Plaster/Drywall, Floor/Carpet, etc.

Table with columns: Bldg Type, SHB+Cons, DixHt, Area, Unit Rate, Grade, Blt/Renov, Replace, Phy Dpr, Fnc Dpr, True Value. Includes details for Dwelling, Shed, and Garage.

Table with columns: front lot, acres/frontage, effective depth, depth factor, actual rate, effective rate, extended value, true value. Includes lot area and value details.