

DUDLEY TWP KENTON SD 00100 Hardin County, Ohio Michael T. Bacon, Auditor 10-260026.0000 RES 2025 I66.01

sale Eff Rate:- 50.85 45.71 48.08 47.49 a/r

Table with columns for year (2022-2025), name (PFEISTER STEVEN R & 12273 TR 205), date (2013-01-09), and area (PT N2 S2 NE4 S6 3.00A IQC).

Table with columns for Tax Year (2022-2025), Prop Cls, Acres, Land100%, Bldg100%, Totl100%, and Tax Value (Land 35%, Bldg 35%, Totl 35%, Hmstd35%, Owner Oc, Hmstd RB, Net Tax, Sp-Asmnt).

Table with columns for SHB+ (1 B), CONS (F PAT STP F), TYPE (M P P G), FACT (2074 448 32 625), SQ-FT (2074 1340 130 15000), VALUE (1340 130 15000), and a *MAIN (a b c d).

Table with columns for Sale# (8 223), #p (1 1), sale date (2013-01-09 2012-06-06), To (PFEISTER STEVEN R & PFEISTER STEVEN R), Type/Invalid? (IQC * IQC *), Sale\$ (0 0), co:land (5430 0), co:bldg (0 0).

Table with columns for Year (2021 2020), Land (6510 6510), Bldg (75390 75390), Total (81900 81900), Net Tax (3804.38 3298.56).

Table with columns for project (500 HARDIN COUNTY LANDFILL), ben acres, and % factor.

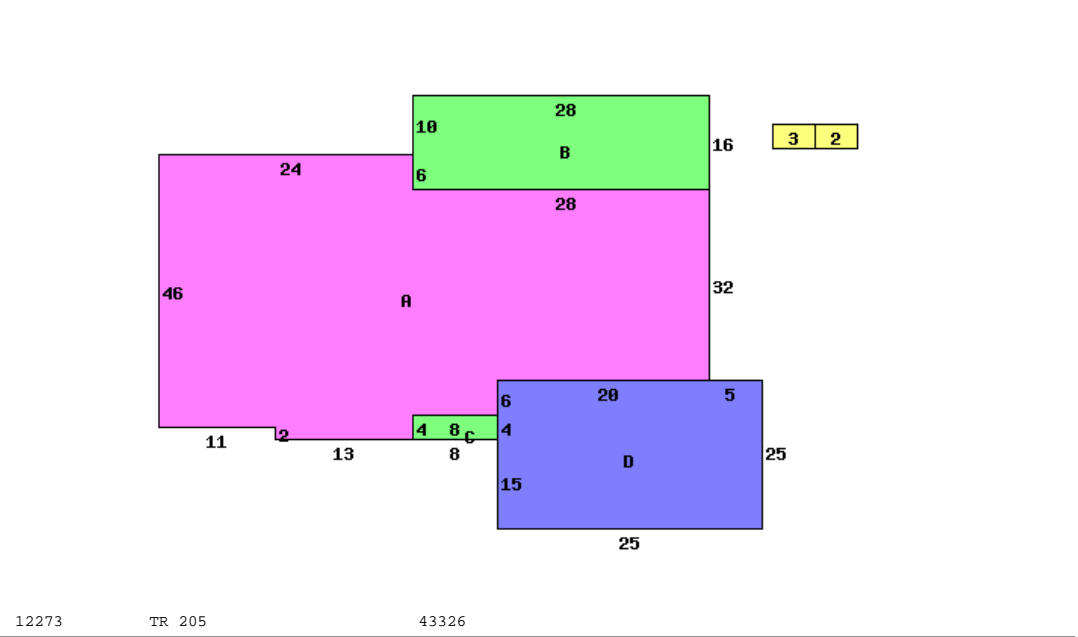

Table with columns for Occupancy (1 Single Family), *DWELLING COMPUTATIONS (Sq-Ft, Value), Story Height (1), Floor Level (Main, Basement, Subtotal), Shingle (Roof), Plaster/Drywall, Unfinished Wall, Floor/Hardwood, Floor/Carpet, Floor/Concrete, Number of Rooms (1 4 Bedrooms), Central Heat, Central A/C, Plumbing (Standard, Extra 3 Fixture).

Table with columns for Bldg Type (1 DWELLING, 2 Pole Build, 3 P, 4 POND), SHB+Cons (1 B F, CAN, *.25ac), DixHt (2074, 9X20, 0), Area (1792, 180, 0), Unit Rate, Grade (C, C, C), Blt/Renov Cond (2012AV, 2012AV, 2012AV), Replace Value (201740, 21500, 1440), Phy Dpr (.10, .35, .35), Fnc Dpr, True Value (216060, 13980, 940, 0).

Table with columns for homesite (1.0000), small acreage (2.0000), effective frontage, depth, actual depth, effective rate, extended value, true value.

Table with columns for PUB ELECTRIC, PRIV WATER, PRIV SEWER, PUB PAVED ST/RD, Neighborhood: Code: (1000), Dwl/Gar/NC% (1.1900).