

DUDLEY TWP KENTON SD 00100 Hardin County, Ohio Michael T. Bacon, Auditor 10-250013.0000 RES 2025 I26

sale

Eff Rate:- 50.85 45.71 48.08 47.49 a/r

Table with columns for year, owner name, and value. Includes entries for 2022-2025 POGUE WILLIAM A & ROS and 2025 POGUE WILLIAM A & ROSE.

Table with columns for Tax Year (2022-2025), Prop Cls, Acres, Land100%, Bldg100%, Totl100%, Cauv100%, Tax Value (Land 35%, Bldg 35%, Totl 35%, Hmstd35%, Owner Oc, Hmstd RB, Net Tax), and Sp-Asmnt.

Table with columns for SHB+, CONS, TYPE, FACT, SQ-FT, VALUE, and a *MAIN. Includes entries for 1 B, 1HB, 1 BA, STP, and OFF.

Table with columns for Sale#, #p, sale date, To, Type/Invalid?, Sale\$, co:land, co:blgd. Includes entries for 543 and 424.

Table with columns for Year, Land, Bldg, Total, Net Tax. Includes entries for 2021 and 2020.

Table with columns for project, ben acres, and % factor. Includes entries for 902 MAIN DISTRICT CONSERVANCY, 158 LAUBIS - SCIOTO RIVER, and 500 HARDIN COUNTY LANDFILL.

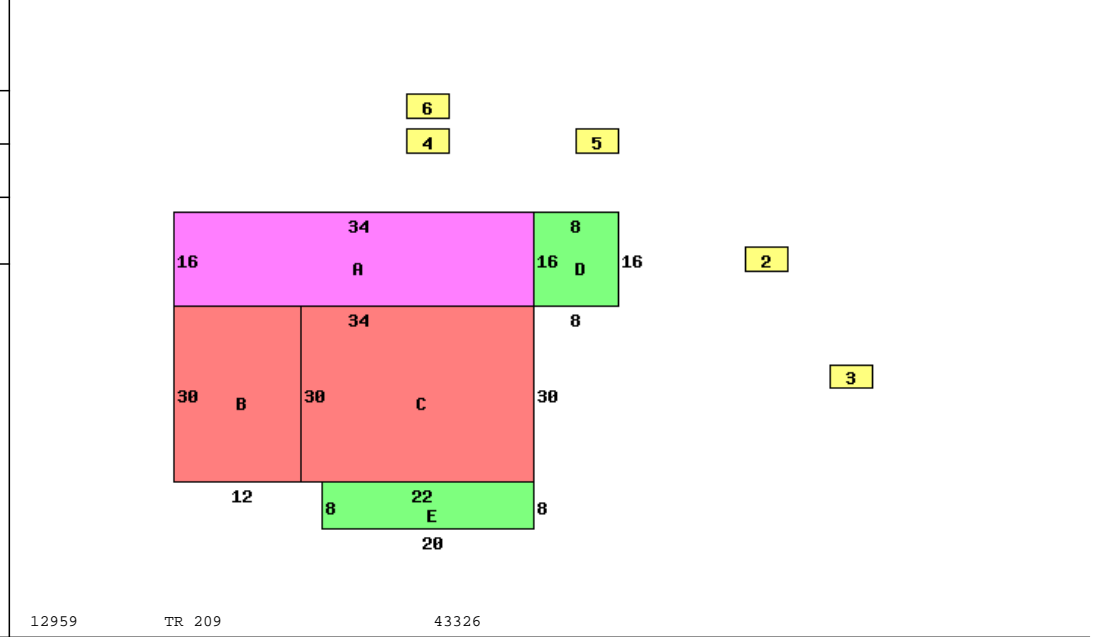

Table with columns for Occupancy, *DWELLING COMPUTATIONS (Sq-Ft, Value), and various building details like Story Height, Floor Level, Main, Part Upper, Qtr Story, Basement, Subtotal, Metal, Roof, GABLE, Plaster/Drywall, Unfinished Wall, Floor/Pine, Number of Rooms, Bedrooms, Central Heat, FORCED AIR, Central A/C, Plumbing, Standard, Extra 3 Fixture, Neighborhood, Code, Dwl/Gar/NC%.

Table with columns for Bldg Type, SHB+Cons, DixHt, Area, Unit Rate, Grade, Blt/Renov, Replace, Phy, Fnc, True Value. Includes entries for 1 DWELLING, 2 Pole Build, 3 Shed, 4 Shed, 5 Shed, 6 Shed.

Table with columns for homesite, small acreage, acres/frontage, effective frontage, depth, actual depth, effective rate, extended value, true value. Includes entries for 1.0000 and 2.0100.

Call Back: Sign: PSN Date: 2015-03-27 Lister: 10-250013.0000-v082020R