

DUDLEY TWP KENTON SD 00100 Hardin County, Ohio Michael T. Bacon, Auditor 10-240021.0000 K59 AGR 2025

sale Eff Rate:- 50.85 45.71 48.08 47.49 a/r

Table with columns: Year, EASH LEVI & ANNIE, 2019-04-11, 2019-04-11, 2019-04-11, 2019-04-11 PT SE4 SW4 & W2 NE4 SW4, 3SD S4 9.901A, \$150,000, KENTON OH 43326

Table with columns: Tax Year (2022-2025), Prop Cls, Acres, Land100%, Bldg100%, Totl100%, Cauv100%, Tax Value (Land 35%, Bldg 35%, Totl 35%, Hmstd35%, Owner Oc, Hmstd RB, Net Tax, Cauv Sav, Sp-Asmnt), CAMA 111, 65690, 106260, 171950t, 37320, 22990, 37190, 60180t, hmstd 5250 l 23220 b

Table with columns: SHB+, CONS, TYPE, FACT, SQ-FT, VALUE, a, \*MAIN, b, PORCH, c, PORCH, d, OTHER

Table with columns: Sale#, #p, sale date, To, Type/Invalid?, Sale\$, co:land, co:bldg

Table with columns: Year, Land, Bldg, Total, Net Tax

Table with columns: project, 158 LAUBIS - SCIOTO RIVER, 902 MAIN DISTRICT CONSERVANCY, 500 HARDIN COUNTY LANDFILL, XA/2025, XA/2025, XA/2025, ben acres / % factor

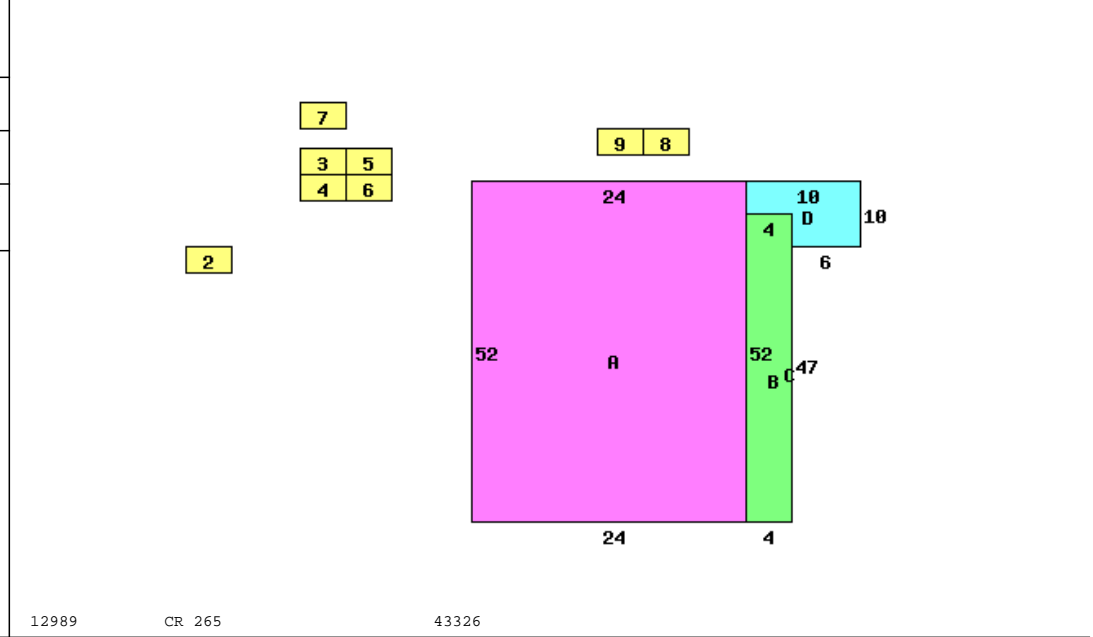

12989 CR 265 43326

Table with columns: Occupancy 1 Single Family, \*DWELLING COMPUTATIONS, Story Height 1, Floor Level, Metal, Plaster/Drywall, Floor/Hardwood, Number of Rooms, Bedrooms, Heating, Plumbing, Extra Features, Total Value, PUB PAVED ST/RD, Neighborhood, Code, Dwl/Gar/NC%

Table with columns: Bldg Type, SHB+Cons, DixHt, Area, Unit Rate, Grade, Blt/Renov, Replace, Phy, Fnc, True, Tab #, S O I L, Acres, Mkt/Ac, Market, Au/Ac, Cauv

Call Back: Sign: PSN Date: 2015-03-16 Lister: 9.901 65690 (100%) 37320 CAUV # 4274 22990 (35%) 13060 10-240021.0000-v082020R