

DUDLEY TWP 00100 Hardin County, Ohio Michael T. Bacon, Auditor 10-240021.0000 AGR 2025 K59

sale Eff Rate:- 50.85 45.71 48.08 47.49 a/r

Table with columns: Year, Sale#, #p, sale date, To, Type/Invalid?, Sale\$, co:land, co:bldg. Includes rows for 2022-2025 EASH LEVI & ANNIE and KENTON OH 43326.

Table with columns: Tax Year, Land 35%, Bldg 35%, Totl 35%, Hmstd35%, Owner Oc, Hmstd RB, Net Tax, Cauv Sav, Sp-Asmnt. Includes tax values for years 2022-2025.

Table with columns: SHB+, CONS, TYPE, FACT, SQ-FT, VALUE, a, \*MAIN. Includes rows for 1 and 04.

Table with columns: Sale#, #p, sale date, To, Type/Invalid?, Sale\$, co:land, co:bldg. Includes rows for 132 and 252.

Table with columns: Year, Land, Bldg, Total, Net Tax. Includes rows for 2021 and 2020.

Table with columns: project, ben acres, /, % factor. Includes rows for 158 LAUBIS - SCIOTO RIVER, 902 MAIN DISTRICT CONSERVANCY, 500 HARDIN COUNTY LANDFILL.

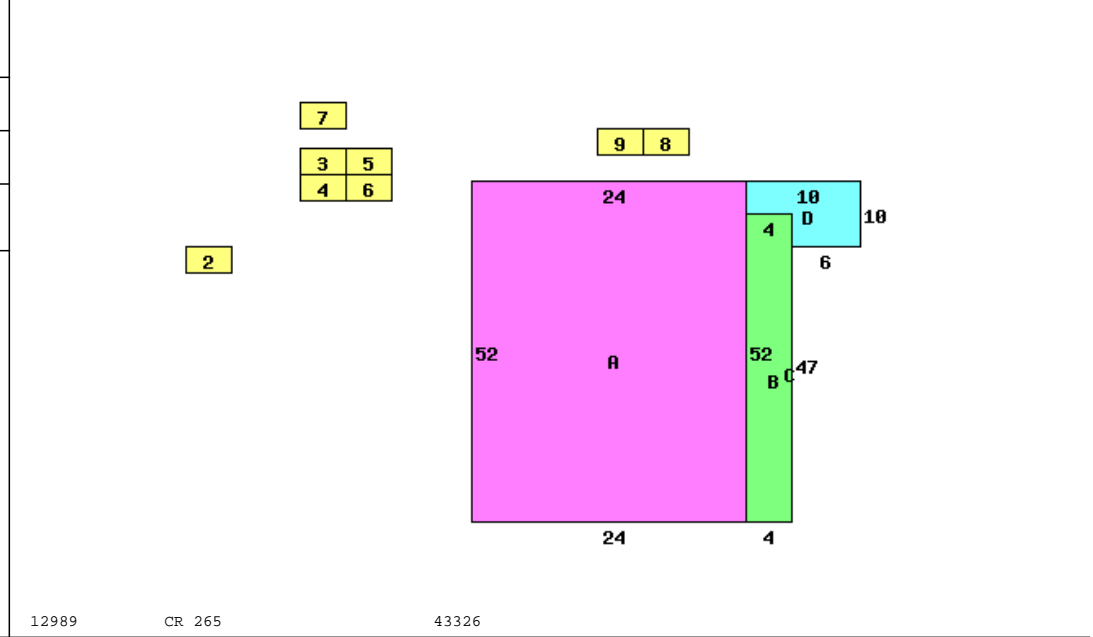

Table with columns: Occupancy, \*DWELLING COMPUTATIONS, Sq-Ft, Value. Includes rows for Single Family, Heating, Plumbing, Extra Features, Total Value, PUB PAVED ST/RD, Neighborhood, Dwl/Gar/NC%.

Table with columns: Bldg Type, SHB+Cons, DixHt, Area, Unit Rate, Grade, Blt/Renov, Replace, Phy, Fnc, True Value. Includes rows for DWELLING, Pole Barn, Flat Barn, Milk Parlo, P, Silo, Pole Build, SOIL, BOA, BOB, HSITE HOMESITE, ROAD ROAD.

Call Back: Sign: PSN Date: 2015-03-16 Lister: 10-240021.0000-v082020R