

DUDLEY TWP KENTON SD 00100 Hardin County, Ohio Michael T. Bacon, Auditor 10-240008.0000 RES 2025 K14

sale

Eff Rate:- 50.85 45.71 48.08 47.49 a/r

Table with columns for year (2022-2025), property name (BRIDENSTINE KIRK A & CR), and address (12476 CR 265). Includes a total value of \$1,691,000.

Table with columns for Tax Year (2022-2025), Prop Cls, Acres, Land100%, Bldg100%, Totl100%, and Cauvl00%. Includes Tax Value breakdown (Land, Bldg, Totl) and Net Tax.

Table with columns for SHB+LHB, CONS, TYPE, FACT, SQ-FT, VALUE, and various codes (a-g).

Table with columns for Sale#, #p, sale date, To, Type/Invalid?, Sales\$, co:land, and co:bldg.

Table with columns for Year, Land, Bldg, Total, and Net Tax for years 2021 and 2020.

Table with columns for project name (HARDIN COUNTY LANDFILL), location (XA/2025), and other details.

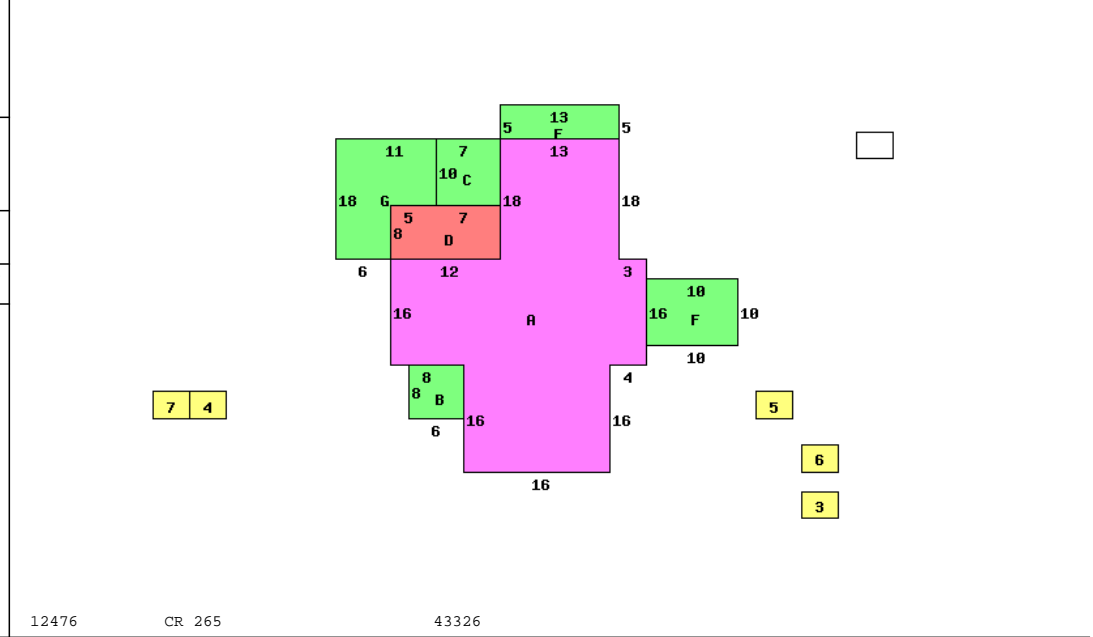

Table with columns for Occupancy (Single Family), \*DWELLING COMPUTATIONS (Sq-Ft, Value), and various building details (Story Height, Floor Level, Shingle, etc.).

Table with columns for Bldg Type, SHB+Cons, DixHt, Area, Unit, Grade, Blt/Renov, Replace, Pfy, Fnc, True Value.

Table with columns for acres/frontage, effective depth, actual rate, effective rate, extended value, true value.

Table with columns for homesite, small acreage, and other property metrics.