

DUDLEY TWP KENTON SD 00100 Hardin County, Ohio Michael T. Bacon, Auditor 10-210010.0000 RES 2025

sale Eff Rate:- 50.85 45.71 48.08 47.49 a/r

Table with columns: Year, Bldg, Land, Total, Net Tax. Rows for 2022, 2023, 2024, 2025.

Table with columns: Tax Year, Prop Cls, Acres, Land100%, Bldg100%, Totl100%, Cauv100%, Tax Value, Land 35%, Bldg 35%, Totl 35%, Hmstd35%, Owner Oc, Hmstd RB, Net Tax, Sp-Asmnt.

Table with columns: SHB+, CONS, TYPE, FACT, SQ-FT, VALUE. Rows for 1 B, 1.

Table with columns: Sale#, #p, sale date, To, Type/Invalid?, Sale\$, co:land, co:bldg. Rows for 593, 589, 325.

Table with columns: Year, Land, Bldg, Total, Net Tax. Rows for 2021, 2020.

Project 500 HARDIN COUNTY LANDFILL XA/2025 ben acres / % factor

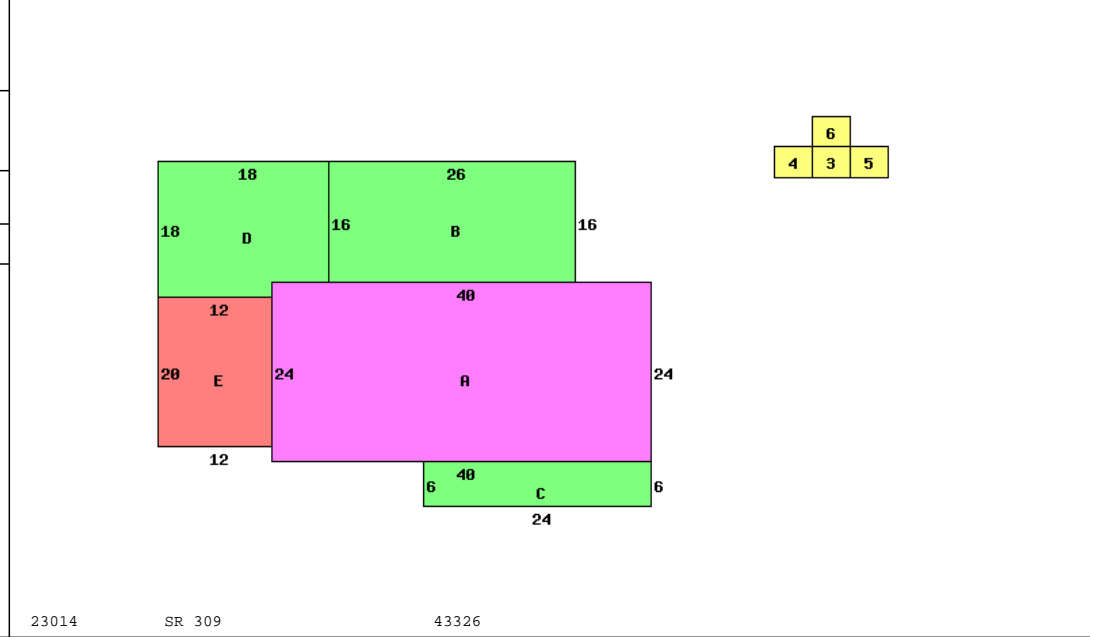

Table with columns: Occupancy, *DWELLING COMPUTATIONS, Sq-Ft, Value. Rows for Story Height, Floor Level, Shingle, Plaster/Drywall, etc.

Table with columns: Bldg Type, SHB+Cons, DixHt, Area, Unit, Grade, Blt/Renov, Replace, Phy, Fnc, True Value. Rows for 1 DWELLING, 3 Garage, 4 Lean-To, 5 Lean-To, 6 Lean-To.

Call Back: Sign: PSN Date: 2015-02-11 Lister: 10-210010.0000-v082020R