

DUDLEY TWP 00100 Hardin County, Ohio Michael T. Bacon, Auditor 10-140008.0000 AGR 2025 KENTON SD

sale Eff Rate:- 50.85 45.71 48.08 47.49 a/r

Table with columns: Year, Sale# #p, sale date, To, Type/Invalid?, Sales\$, co:land, co:blgd. Includes rows for 2022-2025 sales to RABER ADEN & CLARA.

Table with columns: Tax Year, Prop Cls, Acres, Land100%, Bldg100%, Totl100%, Cauv100%, Tax Value, Land 35%, Bldg 35%, Totl 35%, Hmstd35%, Owner Oc, Hmstd RB, Net Tax, Cauv Sav, Sp-Asmnt. Includes values for years 2022-2025.

Table with columns: SHB+, CONS, TYPE, FACT, SQ-FT, VALUE, a, b, c, d, e, f, g, h, i, j, k. Lists various property features and their values.

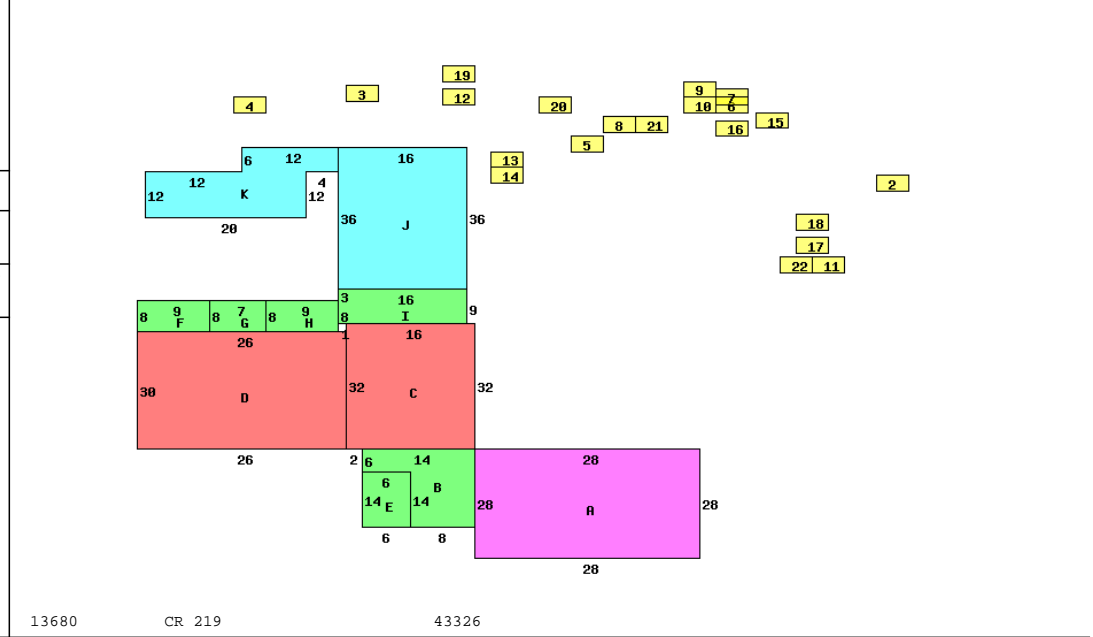

Table with columns: Year, Land, Bldg, Total, Net Tax. Includes a 'project' section for 902 MAIN DISTRICT CONSERVANCY and 500 HARDIN COUNTY LANDFILL.

Table with columns: Occupancy, Story Height, Floor Level, Main, Full Upper, Part Upper, Qtr Story, Basement, Subtotal, Roof, GABLE, Plaster/Drywall, Unfinished Wall, Floor/Plumbing, Extra Features, Number of Rooms, Bedrooms. Includes 'Dwelling Computations' for Sq-Ft and Value.

Table with columns: Bldg Type, SHB+Cons, DixHt, Area, Unit Rate, Grade, Blt/Renov, Cond, Replace, Phy Dpr, Fnc Dpr, True Value. Lists building details for various structures.

Table with columns: Code, Dwl/Gar/NC%, Neighborhood, Value. Includes 'Dwelling Computations' for Value and Neighborhood information.

Table with columns: Tab #, S O I L, Acres, Mkt/Ac, Market, Au/Ac, Cauv. Lists soil and market data for various lots.