

CESSNA TWP  
KENTON SD

00070

Hardin County, Ohio  
Michael T. Bacon, Auditor

07-250046.0000  
J64.01

RES  
2025

sale

Eff Rate:- 49.57 — 43.43 — 45.81 — 45.51 — a/r

2022 SNIDER DEMI	2021-04-08
2023 SNIDER DEMI	2021-04-08
2024 SNIDER DEMI	2021-04-08
2025 SNIDER DEMI	2021-04-08 S2 SW4 NW4 SF25 5.60A
10452 TR 125	1WD
KENTON OH 43326	\$160,000

Tax Year	2022	2023	2024	2025	CAMA
Prop Cls	511	511	511	511	511
Acres	5.6000	5.6000	5.6000	5.6000	
Land100%	22830	32110	32110	32110	32100
Bldg100%	129110	145200	145200	145200	145210
Totl100%	151940t	177310t	177310t	177310t	177310t
Cauvl00%	34600	34600	34600	34600	
Tax Value:					
Land 35%	7990	11240	11240	11240	11240
Bldg 35%	45190	50820	50820	50820	50820
Totl 35%	53180t	62060t	62060t	62060t	62060t
Hmstd35%	47460	53120	53120	53120	
Owner Oc	45.78	46.26	46.20	46.08	hmstd 5250 l 47870 b
Hmstd RB					
Net Tax	3137.14	2432.74	2580.68	2562.94	
Sp-Asmnt	18.00	18.00	47.50	47.50	

Orig Tax Year 2022  
Parent: 07-250010.0000

SHB+	CONS	TYPE	FACT	SQ-FT	VALUE	a	*MAIN
2 B	F	M		672		b	ADDTN
1	F/C	A		400		c	ADDTN
1	F/C	A		240		d	PORCH
	PAT	P		100	300	e	PORCH
	FFP	P		100	4000	f	ADDTN
1	F/C	A		118		g	PORCH
	RFX	P		98	980	h	PORCH
	STP	P		98	390		

Sale#	#p	sale date	To	Type/Invalid?	Sale\$	co:land	co:bldg
126	1	2021-04-08	SNIDER DEMI	1WD	160000	0	0
Year	Land	Bldg	Total	Net Tax			
2021	5650	45190	50840	2286.48			

Project  
902 MAIN DISTRICT CONSERVANCY XA/2025  
500 HARDIN COUNTY LANDFILL XA/2025

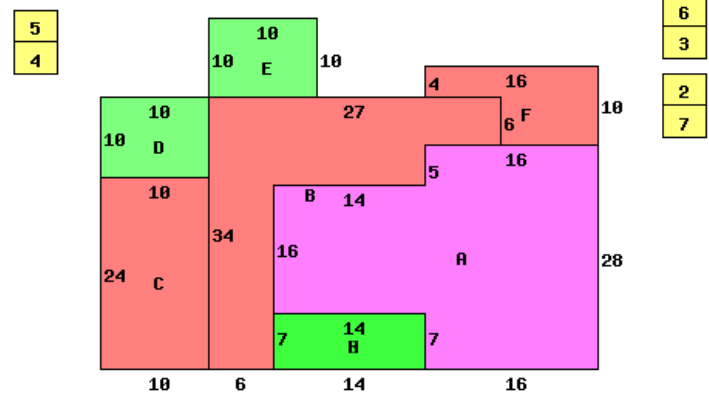

10452 TR 125 43326

Occupancy 1 Single Family	*DWELLING COMPUTATIONS
Story Height 2	Sq-Ft Value
Floor Level	
Main	FRAME 1430 113060
Full Upper	FRAME 672 52250
Basement	224 4590
Subtotal	169900
Shingle	Roof GABLE
Plaster/Drywall	X X Air Conditioning 3790
Unfinished Wall	X Plumbing 2100
Floor/Pine	X X Extra Features 5670
Number of Rooms	1 4 3 Total Value 181460
Bedrooms	1 3
Central Heat	A Neighborhood:
FORCED AIR	Code: 700
Central A/C	A Dwl/Gar/NC% 1.1900
Plumbing	
Standard	1
Extra 3 Fixture	1

Bldg Type	SHB+Cons	DixHt	Area	Unit	Grade	Blt/Renov	Replace	Phy	Fnc	True
1 DWELLING	2 B F	2102	2102		C	1900GD	181460	.40		129560
2 Flat Barn		32X58	1856		D	1951AV	17820	.80	.50	1780
3 Flat Barn		24X30	720		D	OLD/AV	6910	.80	.50	690
4 Garage		24X30	720		C	1950AV	17280	.65		7200
5 Lean-To		14X30	420		C	1950AV	3360	.65		1180
6 Lean-To		30X30	900		C	OLD/AV	7200	.65		2520
7 Lean-To		14X58	812		C	1950AV	6500	.65		2280
homesite	1.0000	effective	depth	actual	effective	extended	true			
small acreage	4.3742	frontage	depth	rate	rate	value	value			
road	.2258		factor	15000	15000	15000	15000			
				5000	3910	17100	17100			