

CESSNA TWP Hardin County, Ohio 07-250005.0000 RES
KENTON SD 00070 Michael T. Bacon, Auditor J07 2023

sale Eff Rate:- 43.60 49.73 49.57 43.43 a/r

Table with columns: Year, Sale, Description, Value, Tax, etc. Includes rows for 2020-2023 TOTTEN RYAN and KENTON OH 43326.

Table with columns: Tax Year, Land 35%, Bldg 35%, Totl 35%, Hmstd 35%, Owner Oc, Hmstd RB, Net Tax, Sp-Asmnt. Includes values for years 2020-2023.

Table with columns: SHB+, CONS, TYPE, FACT, SQ-FT, VALUE, a, *MAIN, b, GRAGE, c, ADDTN, d, ADDTN, e, ADDTN, f, PORCH, g, PORCH, h, ADDTN, i, OTHER.

#: 18 L/W
2013 duplicate combined parcels
072500180000 .333A

Table with columns: Sale#, #p, sale date, To, Type/Invalid?, Sale\$, co:land, co:bldg. Includes historical sale data.

Table with columns: Year, Land, Bldg, Total, Net Tax. Shows tax data for 2019 and 2018.

Project
902 MAIN DISTRICT CONSERVANCY XA/2023
500 HARDIN COUNTY LANDFILL XA/2023

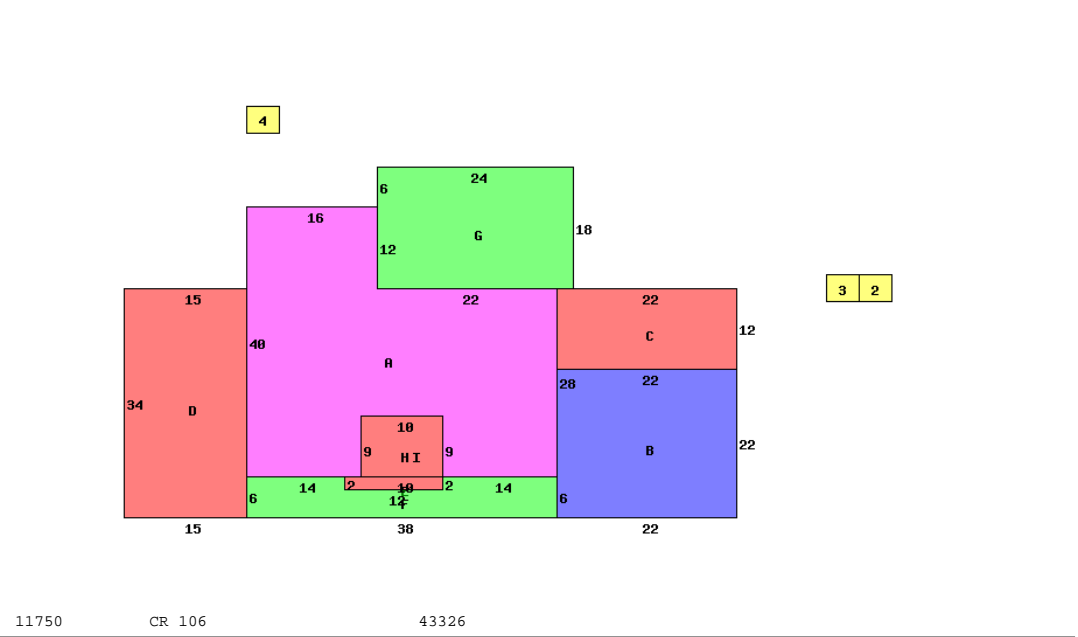

11750 CR 106 43326

Table with columns: Occupancy, *DWELLING COMPUTATIONS, Sq-Ft, Value. Includes details for Single Family, Dwelling, and various fixtures like Fireplaces, Plumbing, etc.

Table with columns: Bldg Type, SHB+Cons, DixHt, Area, Unit Rate, Grade, Blt/Renov, Replace, Phy, Fnc, True Value. Includes details for DWELLING, Pole Build, and POND.

Table with columns: homesite, small acreage, acres/ frontage, effective frontage, depth, actual depth, effective rate, extended value, true value. Includes values for 1.0000, 8.7920, 15000, etc.