

CESSNA TWP Hardin County, Ohio Michael T. Bacon, Auditor 07-250003.0000 RES 2025 KENTON SD 00070 J80.01

sale Eff Rate:- 49.57 43.43 45.81 45.51 a/r

Table with columns for year, address, and value. Includes entries for 2022-2025 LEGGE DOROTHY L LE RO and KENTON OH 43326.

Table with columns for Tax Year (2022-2025), Prop Cls, Acres, Land100%, Bldg100%, Totl100%, and Cauv100%. Includes Tax Value breakdown and Sp-Asmnt.

Table with columns SHB+, CONS, TYPE, FACT, SQ-FT, VALUE, and a \*MAIN. Lists various property features like F/C, EFP, STP, and PORCH.

DOROTHY LEGGE IS AKA DOROTHY MULLETT

Table with columns Sale#, #p, sale date, To, Type/Invalid?, Sales\$, co:land, co:blgd. Shows sales history for LEGGE DOROTHY L.

Table with columns Year, Land, Bldg, Total, Net Tax. Shows tax data for years 2021 and 2020.

Project 902 MAIN DISTRICT CONSERVANCY 500 HARDIN COUNTY LANDFILL XA/2025

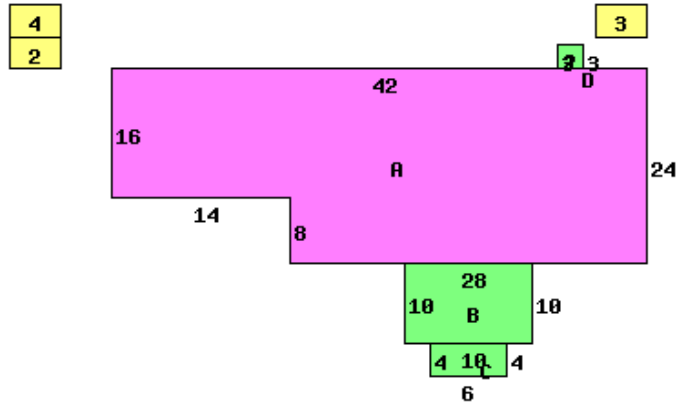

11733 SR 309 43326

Table with columns Occupancy, \*DWELLING COMPUTATIONS, Sq-Ft, Value. Lists details for Single Family occupancy including floor level, shingle, and extra features.

Table with columns Bldg Type, SHB+Cons, DixHt, Area, Unit Rate, Grade, Blt/Renov, Replace, Phy Dpr, Fnc Dpr, True Value. Includes details for Dwelling, Garage, and Upground C.

Table with columns homesite, acres/frontage, effective frontage, depth, actual depth, effective rate, extended value, true value. Includes Call Back, Sign, PSN Date, and Lister information.