

CESSNA TWP Hardin County, Ohio Michael T. Bacon, Auditor 07-230021.0000 RES 2025 KENTON SD 00070 J31

sale

Eff Rate:- 49.57 43.43 45.81 45.51 a/r

Table with columns: Year, Description, Date, Area, Value. Includes rows for 2022-2025 Anderson Rosalind L T and KENTON OH 43326.

Table with columns: Tax Year, Prop Cls, Acres, Land100%, Bldg100%, Totl100%, Cauv100%, Tax Value, Land 35%, Bldg 35%, Totl 35%, Hmstd35%, Owner Oc, Hmstd RB, Net Tax, Sp-Asmnt. Includes rows for years 2022-2025 and various tax values.

Table with columns: SHB+, CONS, TYPE, FACT, SQ-FT, VALUE, a, *MAIN, b, PORCH, c, PORCH, d, ADDTN, e, GRAGE, f, ADDTN, g, PORCH. Includes rows for 1, 1, 1.

Table with columns: Sale#, #p, sale date, To, Type/Invalid?, Sales\$, co:land, co:bldg. Includes rows for 213, 500, 374.

Table with columns: Year, Land, Bldg, Total, Net Tax. Includes rows for 2021, 2020.

Table with columns: project, ben acres, /, %, factor. Includes rows for 902 MAIN DISTRICT CONSERVANCY and 500 HARDIN COUNTY LANDFILL.

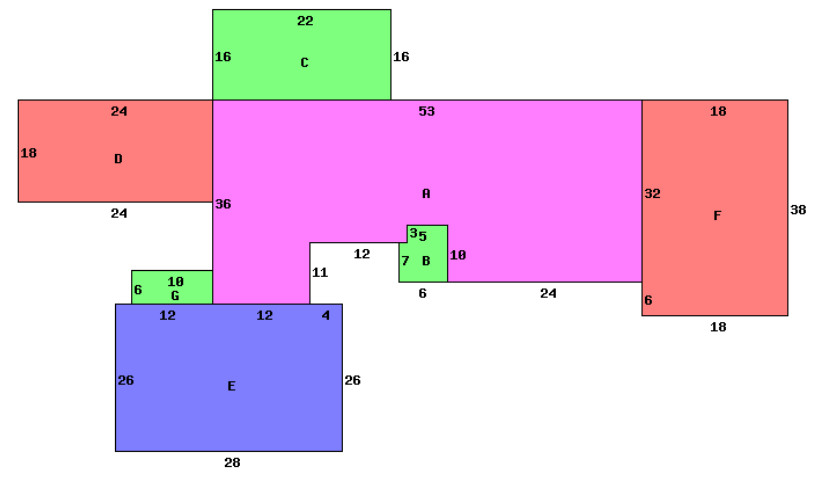

9564 TR 115 43326

Table with columns: Occupancy, *DWELLING COMPUTATIONS, Sq-Ft, Value. Includes rows for Story Height, Floor Level, Shingle, Plaster/Drywall, etc.

Table with columns: Bldg Type, SHB+Cons, DixHt, Area, Unit Rate, Grade, Blt/Renov, Replace, Phy Fnc, True Value. Includes rows for 1 DWELLING, homesite, small acreage.

Table with columns: homesite, small acreage, effective frontage, depth, actual rate, effective rate, extended value, true value. Includes rows for homesite, small acreage.