

CESSNA TWP Hardin County, Ohio Michael T. Bacon, Auditor 07-150034.0000 RES 2025 KENTON SD 00070 H48.01

sale Eff Rate:- 49.57 43.43 45.81 45.51 a/r

Table with columns for year (2022-2025), description (GEHMAN LLOYD M & ANNA), and value (\$115,801).

Table with columns for Tax Year (2022-2025), Prop Cls, Acres, Land100%, Bldg100%, Totl100%, and Cauv100%.

Orig Tax Year 1999 Parent: 07-150018.0000

Table with columns for Tax Value (Land 35%, Bldg 35%, Totl 35%, Hmstd35%, Owner Oc, Hmstd RB, Net Tax) and Sp-Asmnt.

Table with columns for SHB+, CONS, TYPE, FACT, SQ-FT, VALUE, and a *MAIN.

gas fireplace

Table with columns for Sale#, #p, sale date, To, Type/Invalid?, Sales\$, co:land, co:bldg.

Table with columns for Year, Land, Bldg, Total, Net Tax.

Table with columns for project, ben acres, and % factor.

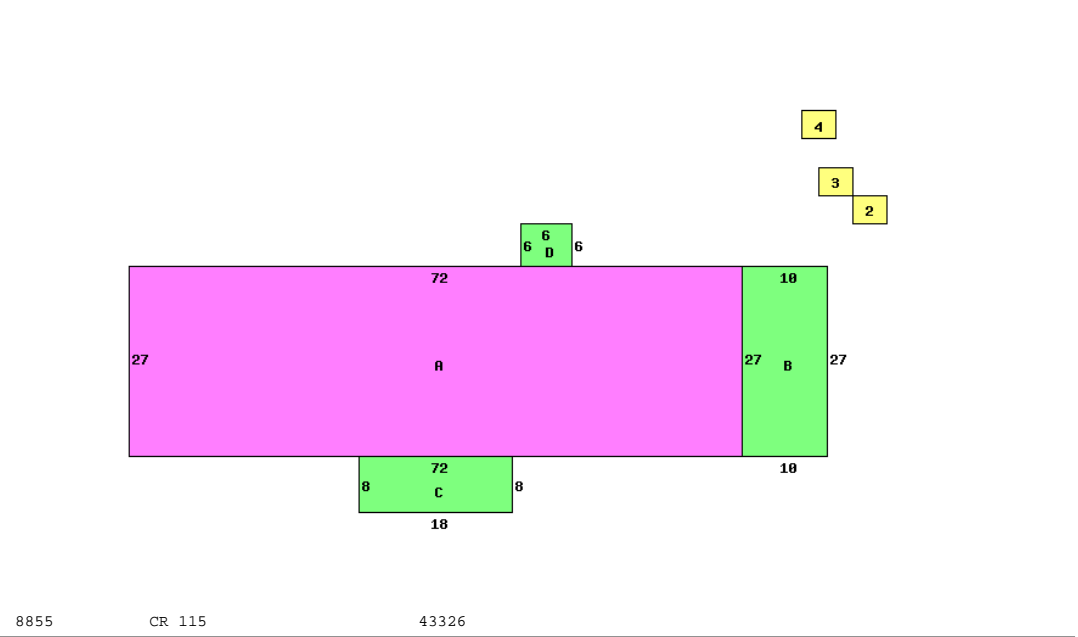

8855 CR 115 43326

Table with columns for Occupancy 4 M/H on Real Estate, *DWELLING COMPUTATIONS, Story Height, Floor Level, Metal, B 1 2 U A.

Table with columns for Bldg Type, SHB+Cons, DixHt, Area, Unit Rate, Grade, Blt/Renov, Replace, Phy Fnc, True Value.

Table with columns for Plaster/Drywall, Floor/Carpet, Floor/Tile-Lino, Number of Rooms, Bedrooms, Central Heat, Forced Air, Central A/C, Plumbing, Standard, Extra 3 Fixture.

Table with columns for homesite, small acreage, acres/ frontage, effective frontage, depth, actual depth, effective rate, extended value, true value.