

CESSNA TWP Hardin County, Ohio Michael T. Bacon, Auditor 07-150025.0000 RES 2025 KENTON SD 00070 H58

sale

Eff Rate:- 49.57 43.43 45.81 45.51 a/r

Table with columns: Year, Property Description, Date, Price, Location. Includes entries for 2022-2025 SHEPHERD KIRK B & DEB and 2025 SHEPHERD KIRK B & DEBRA.

Table with columns: Tax Year, Prop Cls, Acres, Land100%, Bldg100%, Totl100%, Cauv100%, Tax Value, Hmstd, Net Tax, Sp-Asmnt. Includes rows for years 2022-2025 and various tax metrics.

Table with columns: SHB+, CONTS, TYPE, FACT, SQ-FT, VALUE, a, *MAIN, b, ADDTN, c, GRAGE, d, PORCH, e, ADDTN, f, PORCH, g, PORCH, h, PORCH.

Table with columns: Sale#, #p, sale date, To, Type/Invalid?, Sales\$, co:land, co:bldg. Includes rows for sales 51, 208, 622, 17.

Table with columns: Year, Land, Bldg, Total, Net Tax. Includes rows for years 2021 and 2020.

Table with columns: project, 902 MAIN DISTRICT CONSERVANCY, 500 HARDIN COUNTY LANDFILL, XA/2025, XA/2025, ben acres, / % factor.

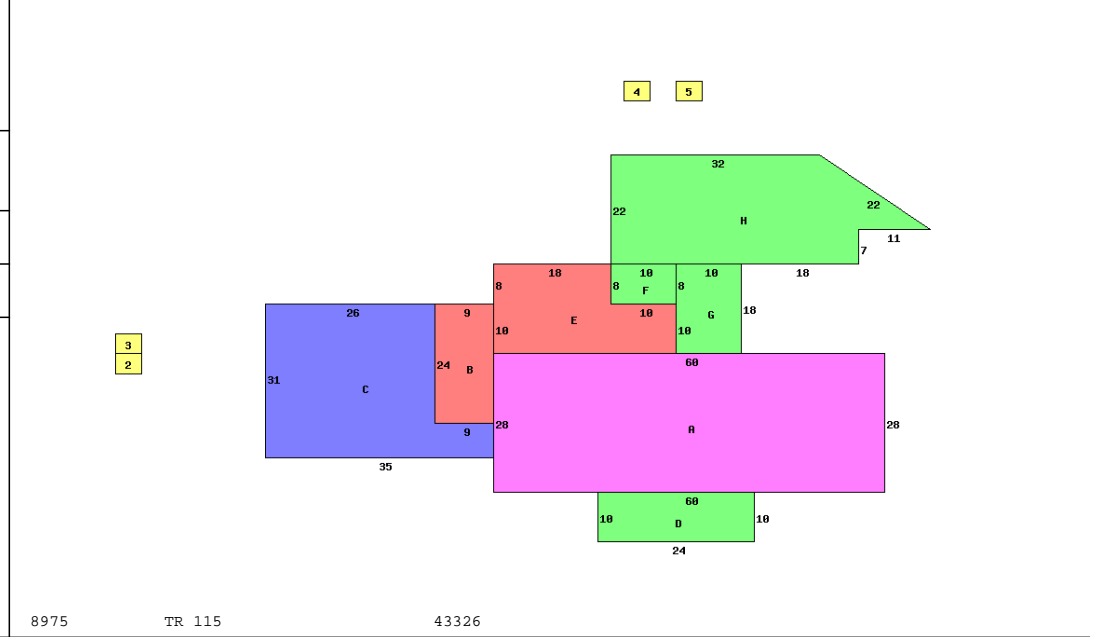

Table with columns: Occupancy, *DWELLING COMPUTATIONS, Sq-Ft, Value. Includes rows for Story Height, Floor Level, Shingle, Plaster/Drywall, etc.

Table with columns: Bldg Type, SHB+Cons, DixHt, Area, Unit, Rate, Grade, Blt/Renov, Replace, Phy, Fnc, True Value. Includes rows for Dwelling, Pole Build, Pond, and homesite/acreage.

Call Back: Sign: PSN Date: 2015-04-16 Lister: 07-150025.0000-v082020R