

BUCK TWP
SOUTH KENTON CORP

00060

Hardin County, Ohio
Michael T. Bacon, Auditor

06-100033.0000
HH108

RES
2023

sale

Eff Rate:- 44.63 — 50.76 — 50.59 — 44.66 — a/r

2020 BRACE GARY M	2008-09-17
2021 BRACE GARY M	2008-09-17
2022 BRACE GARY M	2008-09-17
2023 BRACE GARY M	2008-09-17 LETSONS 19
118 E ESPY ST	LWD
KENTON OH 43326	\$25,000 12.1-05-10-033

Tax Year	2020	2021	2022	2023	CAMA
Prop Cls	510	510	510	510	510
Acres	5890	5890	5890	8370	8380
Land100%	41600	41600	41600	50340	50340
Bldg100%	47490t	47490t	47490t	58710t	58720t
Totl100%					
Cauvl00%					
Tax Value:					
Land 35%	2060	2060	2060	2930	2930
Bldg 35%	14560	14560	14560	17620	17620
Totl 35%	16620t	16620t	16620t	20550t	20550t
Hmstd35%					
Owner Oc					
Hmstd RB					
Net Tax	676.80	779.20	776.36	844.96	
Sp-Asmnt	54.85	21.02	21.01	21.01	

SHB+	CONS	TYPE	FACT	SQ-FT	VALUE	a	*MAIN
1	F/C	M		1299			
	EFP	P		84	3360	b	PORCH
	EFP	P		35	1400	c	PORCH
	OFF	P		245	7350	d	PORCH

Sale#	#p	sale date	To	Type/Invalid?	Sale\$	co:land	co:bldg
474	1	2008-09-17	BRACE GARY M	LWD *	25000	5170	31570
180	1	2008-05-14	MABREY JAMES D & IRA E	1AF *	0	5170	31570
133	1	1997-04-16	MABREY JAMES D & IRA E	LWD *	0	4890	21570

Year	Land	Bldg	Total	Net Tax
2019	1960	11620	13580	534.76
2018	1960	11620	13580	535.32

project	ben acres	/ %	factor
902 MAIN DISTRICT CONSERVANCY			
500 HARDIN COUNTY LANDFILL			

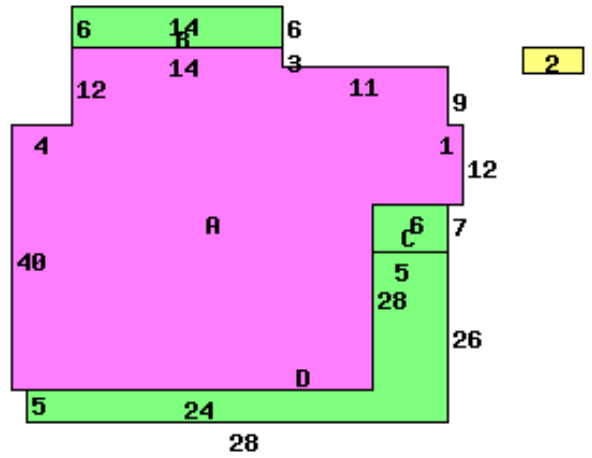

118 E ESPY ST 43326

Occupancy 1 Single Family	*DWELLING COMPUTATIONS
Story Height 1	Sq-Ft Value
Floor Level	1299 107390
Metal	107390
Plaster/Drywall	12110
Floor/Carpet	119500
Number of Rooms	
Bedrooms	
Central Heat	
FORCED AIR	3600
Plumbing	.9700
Standard	

Bldg Type	SHB+Cons	DixHt	Unit	Blt/Renov	Replace	Phy	Fnc	True
1 DWELLING	1 F/C	1299		C-	1920AV	.55		46950
2 Garage		16X26	416	C	1950AV	.65		3390
front lot	66.0000	66.00	170	106	120	127	8380	8380