

BUCK TWP  
SOUTH KENTON CORP

00060

Hardin County, Ohio  
Michael T. Bacon, Auditor

06-002599.9999

RES  
2025

sale

|                      |                     |            |
|----------------------|---------------------|------------|
| 2022                 | RODENBERGER JASON R | 2005-08-01 |
| 2023                 | RODENBERGER JASON R | 2005-08-01 |
| 2024                 | RODENBERGER JASON R | 2005-08-01 |
| 2025                 | RODENBERGER JASON R | 2005-08-01 |
| 150 HARRIS ST LOT 23 |                     |            |
| KENTON OH 43326      |                     |            |
|                      |                     | \$0        |

|            |       |       |       |       |          |
|------------|-------|-------|-------|-------|----------|
| Eff Rate:- | 50.76 | 50.59 | 44.66 | 47.03 | a/r      |
| Tax Year   | 2022  | 2023  | 2024  | 2025  |          |
| Prop Cls   | 0     | 0     | 0     | 0     | CAMA 570 |
| Acres      |       |       |       |       |          |
| Land100%   |       |       |       |       |          |
| Bldg100%   | 1140  | 1140  | 1140  | 1140  | 400      |
| Totl100%   | 1140t | 1140t | 1140t | 1140t | 400t     |
| Cauv100%   |       |       |       |       |          |
| Tax Value: |       |       |       |       |          |
| Land 35%   | 400   | 400   | 400   | 400   | 140      |
| Bldg 35%   | 400t  | 400t  | 400t  | 400t  | 140t     |
| Totl 35%   |       |       |       |       |          |
| Hmstd35%   | .14   | .14   | .12   | .12   |          |
| Owner Oc   |       |       |       |       |          |
| Hmstd RB   |       |       |       |       |          |
| Net Tax    | 6.44  | 6.40  | 5.64  | 5.98  |          |

| SHB+  | CONS | TYPE       | FACT                | SQ-FT   | VALUE |               |        |
|-------|------|------------|---------------------|---------|-------|---------------|--------|
| 50    |      | O          |                     | 784     | 31360 | a             | OTHER  |
|       | CVP  | P          |                     | 176     | 4050  | b             | PORCH  |
| Sale# | #p   | sale date  | To                  |         |       | Type/Invalid? | Sale\$ |
| 33    | 1    | 2005-08-01 | JASON R RODENBERGER |         |       | E X           | 0      |
| Year  | Land | Bldg       | Total               | Net Tax |       |               |        |
| 2021  | 0    | 400        | 400                 | 5.58    |       |               |        |
| 2020  | 0    | 400        | 400                 | 5.36    |       |               |        |

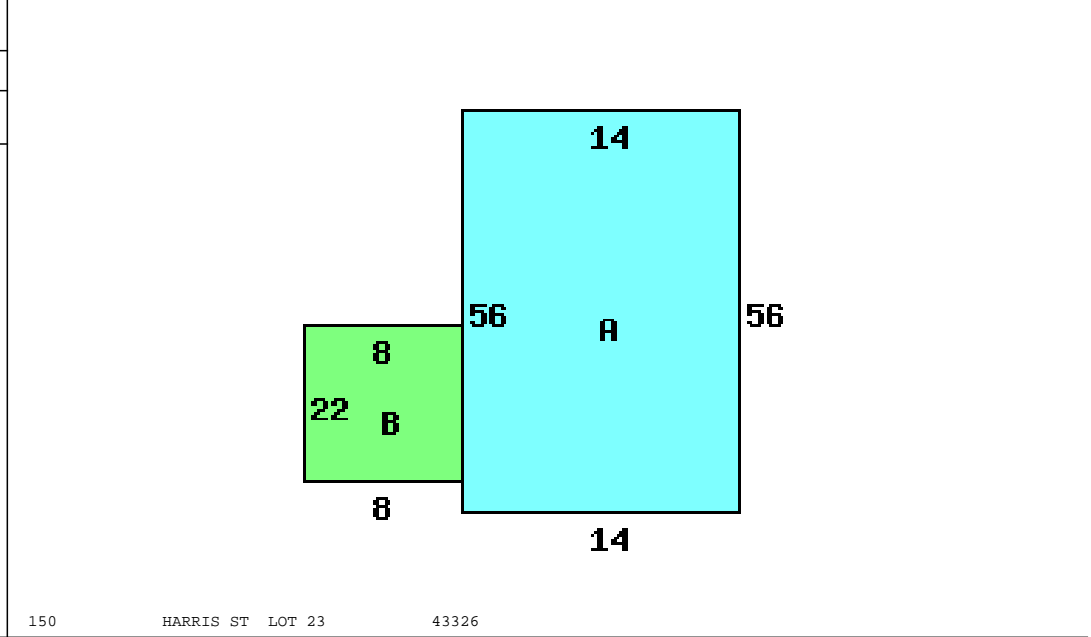

|                 |       |
|-----------------|-------|
| Occupancy 8 M/H |       |
| B 1 2 U A       |       |
| Extra Features  | 35410 |
| Total Value     | 35410 |
| Neighborhood:   |       |
| Code:           | 9290  |

| Bldg Type | SHB+Cons | DixHt | Area | Unit | Blt/Renov | Replace | Phy | Fnc | True  |
|-----------|----------|-------|------|------|-----------|---------|-----|-----|-------|
| 1 MH/LRE  | *SV      | 14X56 | 0    | Rate | Grade     | Cond    | Dpr | Dpr | Value |
|           |          |       |      |      |           | 1974FR  |     |     | 400   |