

BUCK TWP
RIDGEMONT SD

00050

Hardin County, Ohio
Michael T. Bacon, Auditor

05-180049.0000
A17.01

AGR
2025

sale

Eff Rate:- 39.00 41.37 41.16 a/r

2023 BORNTREGER ELI & MART
2024 GLICK HARLEY & LOVINA
2025 GLICK HARLEY & LOVINA E
17636 CR 265
KENTON OH 43326

2023-12-13
2023-12-13 10016 10171 44.502A
1SD
\$611,478

Tax Year	2023	2024	2025	CAMA
Prop Cls	111	111	111	111
Acres		44.5020	44.5020	
Land100%		260430	260430	260430
Bldg100%	101060	101060	101060	101050
Totl100%	101060t	361490t	361490t	361480t
Cauv100%	119090	119090	119090	119080
Tax Value:				
Land 35%	41680	41680	41680	91150
Bldg 35%	35370	35370	35370	35370
Totl 35%	77050t	77050t	77050t	126520t
Hmstd35%			36030	
Owner Oc	31.46		31.32	
Hmstd RB	317.58			
Net Tax	2386.40	2918.88	2871.96	
Sp-Asmnt		1874.06	1864.04	
		39.86	39.86	

Orig Tax Year 2024
Parent: 05-180001.0000

hmstd 5250 1 30780 b

SHB+	CONS	TYPE	FACT	SQ-FT	VALUE	a	*MAIN
2	F/C	M		684			ADDTN
1	F	A		720			GRAGE
	F	G		600	14400		PORCH
	STP	P		16	60		OTHER
04	F	O		64	770		

#: 66 L/W
051400660000 .056A

Sale#	#p	sale date	To	Type/Invalid?	Sales\$	co:land	co:blgd
530	1	2023-12-13	GLICK HARLEY & LOVINA	ETA LSD	611478	0	101060

Project	ben acres	/	%	factor
500 HARDIN COUNTY LANDFILL				XA/2025
902 MAIN DISTRICT CONSERVANCY				XA/2025

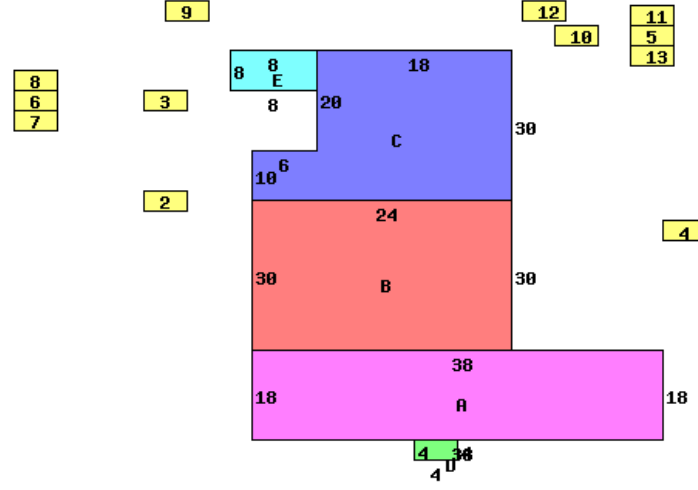

17636 CR 265 43326

Occupancy 1 Single Family		*DWELLING COMPUTATIONS	
Story Height	2	Sq-Ft	Value
Floor Level	Main	FRAME	1404 111000
	Full Upper	FRAME	684 53180
	Basement		720 13610
	Subtotal		177790
Metal	Roof	GABLE	
Plaster/Drywall	D D		Garages and Carports 14400
Floor/Pine	X X		Extra Features 830
Floor/Carpet	X		Total Value 193020
Number of Rooms	1 4 3		
Bedrooms	3		
Central Heat	A	Neighborhood:	400
FORCED AIR		Code:	1.2500
Plumbing		Dwl/Gar/NC%	
Standard	1		

Bldg Type	SHB+Cons	DixHt	Area	Unit Rate	Grade	Blt/Renov	Cond	Replace Value	Phy Dpr	Fnc Dpr	True Value
1 DWELLING	2 F/C		2088		C-	OLD/AV		173720	.55	.10	87950
2 Poultry Ho	*NV	15X30	450			OLD/AV		0			0
3 Shed	*SV	14X24	336			OLD/		500			500
4 Shed		24X50	1200		D	1975FR		11520	.70	.50	1730
5 Flat Barn		36X90	3240		D	1977FR		31100	.80	.50	3110
6 Bank Barn		30X52	1560		D	1977FR		14980	.70	.50	2250
7 Lean-To		13X52	676		D	1989FR		4330	.70	.50	650
8 Lean-To		12X52	624		D	1989FR		3990	.70	.50	600
9 Hog House		36X34	1224		D	1989FR		14690	.70	.50	2200
10 Silo	*NV	12X40	480			1900PR		0			0
11 Lean-To		10X40	400		D	1977FR		2560	.70	.20	610
12 Lean-To		24X26	624		D	1975FR		3990	.70	.20	960
13 Lean-To		8X40	320		D	1977FR		2050	.70	.20	490

Tab #	S O I L	Acres	Mkt/Ac	Market	Au/Ac	Cauv
C 1	BOA BLOUNT SILT LOAM 0-	1.1200	6030	6750	2660	2980
C 2	BOB BLOUNT SILT LOAM, 2	12.7250	5770	73420	2360	30030
C 14	GWB GLYNWOOD SILT LOAM	9.8200	5400	53030	1750	17190
C 15	GYB2 GLYNWOOD CLAY LOAM	4.6300	5020	23240	1230	5700
C 39	PM PEWAMO SILTY CLAY L	13.4370	6490	87210	3560	47840
W 2	BOB BLOUNT SILT LOAM, 2	.3700	3130	1160	470	170
W 14	GWB GLYNWOOD SILT LOAM	.2200	2830	620	750	170
670	HSITE HOMESITE	1.0000	15000	15000	15000	15000
980	ROAD ROAD	1.1800				

44.502 260430 (100%) 119080 CAUV # 4596
91150 (35%) 41680