

BUCK TWP  
RIDGEMONT SD

00050

Hardin County, Ohio  
Michael T. Bacon, Auditor

05-180004.0000  
A04

AGR  
2025

sale

Eff Rate:- 46.89 — 39.00 — 41.37 — 41.16 — a/r

|                             |            |                  |
|-----------------------------|------------|------------------|
| 2022 YODER ALBERT H & CLAR  | 2005-02-23 |                  |
| 2023 YODER ALBERT H & CLAR  | 2005-02-23 |                  |
| 2024 YODER ALBERT H & CLAR  | 2005-02-23 |                  |
| 2025 YODER ALBERT H & CLARA | 2005-02-23 | 10016 ETC 73.65A |
| 17241 TR 265                | 1SD        |                  |
| KENTON OH 43326             | \$210,000  |                  |

|            |         |         |         |         |                      |
|------------|---------|---------|---------|---------|----------------------|
| Tax Year   | 2022    | 2023    | 2024    | 2025    | CAMA                 |
| Prop Cls   | 111     | 111     | 111     | 111     | 111                  |
| Acres      | 73.6500 | 73.6500 | 73.6500 | 73.6500 |                      |
| Land100%   | 368600  | 402910  | 402910  | 402910  | 402920               |
| Bldg100%   | 197660  | 234910  | 234910  | 234910  | 234920               |
| Totl100%   | 566260t | 637830t | 637830t | 637830t | 637840t              |
| Cauv100%   | 93860   | 180430  | 180430  | 180430  | 180430               |
| Tax Value: |         |         |         |         |                      |
| Land 35%   | 32850   | 63150   | 63150   | 63150   | 141020               |
| Bldg 35%   | 69180   | 82220   | 82220   | 82220   | 82220                |
| Totl 35%   | 102030t | 145370t | 145370t | 145370t | 223240t              |
| Hmstd35%   | 45710   | 53870   | 53870   | 53650   |                      |
| Owner Oc   | 47.42   | 47.04   | 47.00   | 46.64   | hmstd 3220 l 50430 b |
| Hmstd RB   |         |         |         |         |                      |
| Net Tax    | 4313.80 | 5113.90 | 5460.04 | 5430.96 |                      |
| Cauv Sav   | 4110.26 | 2764.54 | 2949.94 | 2934.18 |                      |
| Sp-Asmnt   | 32.16   | 32.16   | 56.76   | 56.76   |                      |

|      |      |      |      |       |       |   |       |
|------|------|------|------|-------|-------|---|-------|
| SHB+ | CONS | TYPE | FACT | SQ-FT | VALUE | a | *MAIN |
| 2    | F/C  | M    |      | 136   |       | b | PORCH |
|      | OFF  | P    |      | 520   | 15600 | c | ADDTN |
| 2 B  | F    | A    |      | 1360  |       | d | PORCH |
|      | OFF  | P    |      | 210   | 8400  | e | OTHER |
| 04   | F    | O    |      | 480   | 5760  | f | PORCH |
|      | OFF  | P    |      | 30    | 900   |   |       |

SEE 004L FOR SCHOOL #: 19-003 L/W  
10-14-16 16173 TR 265 ADDRESS GIVEN TO CEMETERY  
051900030000 65.50a

|       |       |            |                          |               |        |         |         |
|-------|-------|------------|--------------------------|---------------|--------|---------|---------|
| Sale# | #p    | sale date  | To                       | Type/Invalid? | Sale\$ | co:land | co:blgd |
| 117   | 1     | 2005-02-23 | YODER ALBERT H & CLARA M | 1SD           | 210000 | 128940  | 133030  |
| Year  | Land  | Bldg       | Total                    | Net Tax       |        |         |         |
| 2021  | 32850 | 69180      | 102030                   | 4389.72       |        |         |         |
| 2020  | 32850 | 69180      | 102030                   | 4375.26       |        |         |         |

Project  
902 MAIN DISTRICT CONSERVANCY XA/2025  
500 HARDIN COUNTY LANDFILL XA/2025  
ben acres / % factor

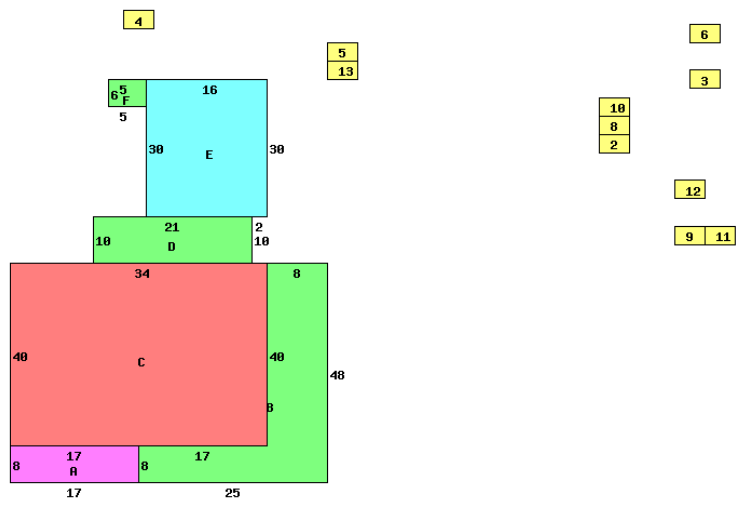

17241 TR 265 43326

|                           |                            |
|---------------------------|----------------------------|
| Occupancy 1 Single Family | *DWELLING COMPUTATIONS     |
| Story Height 2            | Sq-Ft Value                |
| Floor Level               |                            |
| Main                      | FRAME 1496 117750          |
| Full Upper                | FRAME 1496 70640           |
| Basement                  | 1360 25170                 |
| Subtotal                  | 213560                     |
| Metal                     | Roof GABLE                 |
| Plaster/Drywall           | D D Heating -3440          |
| Floor/Pine                | X X Plumbing -3800         |
| Number of Rooms           | 1 4 6 Extra Features 30660 |
| Bedrooms                  | 1 6 Total Value 236980     |
|                           | PUB ELECTRIC               |
|                           | PRIV WATER                 |
|                           | PUB PAVED ST/RD            |
|                           | Topo: ROLLING              |
|                           | Neighborhood:              |
|                           | Code: 400                  |
|                           | Dwl/Gar/NC% 1.2500         |

|              |          |            |      |       |           |         |     |     |        |
|--------------|----------|------------|------|-------|-----------|---------|-----|-----|--------|
| Bldg Type    | SHB+Cons | DixHt      | Unit | Grade | Blt/Renov | Replace | Phy | Fnc | True   |
| 1 DWELLING   | 2 F/C    | 2992       |      | D     | 1993AV    | 189580  | .24 | .20 | 144080 |
| 2 Lean-To    |          | 18X20 360  |      | D     | 1970FR    | 2300    | .70 | .20 | 550    |
| 3 Shed       |          | 24X48 1152 |      | D     | OLD/PR    | 11060   | .75 | .20 | 2210   |
| 4 Shed       |          | 28X48 1344 |      | D     | 1960FR    | 10320   | .70 | .20 | 2480   |
| 5 Shop-Stud  | 1 F 0    | 36X60 2160 |      | D     | 1990AV    | 25920   | .65 | .20 | 7260   |
| 6 Crib/Grana |          | 36X46 1656 |      | D     | OLD/FR    | 13250   | .70 | .20 | 3180   |
| 8 Flat Barn  | 1 F      | 50X84 4200 |      | D     | 1970AV    | 40320   | .80 | .50 | 4030   |
| 9 Finishing  | 1 M 0    | 32X90 2880 |      | D     | 1987AV    | 34560   | .65 | .20 | 9680   |
| 10 Lean-To   |          | 24X30 720  |      | D     | 1996AV    | 4610    | .60 | .20 | 1480   |
| 11 P         | *SV CAN  | 10X90 900  |      |       | 1987AV    | 200     |     |     | 200    |
| 12 Silo      | *NV      | 10X37 370  |      |       | 1990FR    | 0       |     |     | 0      |
| 13 P         | RFX      | 6X36 216   |      | D     | OLD/FR    | 1730    | .70 | .20 | 420    |
| 15 Shed      |          | 12X36 432  |      | D     | OLD/FR    | 4150    | .70 | .20 | 1000   |
| 16 Shed      | *PP      | 8X16 120   |      |       | OLD/AV    | 0       |     |     | 0      |

|       |                           |         |        |        |       |       |
|-------|---------------------------|---------|--------|--------|-------|-------|
| Tab # | S O I L                   | Acres   | Mkt/Ac | Market | Au/Ac | Cauv  |
| C 1   | BOA BLOUNT SILT LOAM 0-   | 8.3937  | 6030   | 50610  | 2660  | 22330 |
| C 2   | BOB BLOUNT SILT LOAM, 2   | 30.8185 | 5770   | 177820 | 2360  | 72730 |
| C 8   | EE EEL SILT LOAM, OCCA    | 5.5954  | 5550   | 31050  | 2460  | 13770 |
| C 14  | GWB GLYNWOOD SILT LOAM    | 3.1622  | 5400   | 17080  | 1750  | 5530  |
| C 15  | GYB2 GLYNWOOD CLAY LOAM   | 5.6873  | 5020   | 28550  | 1230  | 7000  |
| C 17  | HKA HASKINS SILT LOAM 0   | .1756   | 5900   | 1040   | 2950  | 520   |
| C 39  | PM PEWAMO SILTY CLAY L    | 10.1703 | 6490   | 66010  | 3560  | 36210 |
| C 50  | WE WESTLAND CLAY LOAM     | .6771   | 7650   | 5180   | 4060  | 2750  |
| W 2   | BOB BLOUNT SILT LOAM, 2   | 1.3500  | 3130   | 4230   | 470   | 640   |
| W 2   | BOB BLOUNT SILT LOAM, 2   | .8106   | 3130   | 2540   | 470   | 380   |
| C 51  | WSTL WASTE LAND           | 3.4219  | 120    | 410    | 50    | 170   |
| 680   | HSITE HOMESITE - AMISH DW | 1.0000  | 9200   | 9200   | 9200  | 9200  |
| 980   | ROAD ROAD                 | 1.3874  |        |        |       |       |
| 680   | HSITE HOMESITE - AMISH DW | 1.0000  | 9200   | 9200   | 9200  | 9200  |

73.65 402920 (100%) 180430 CAUV # 3348  
141020 (35%) 63150

BUCK TWP  
RIDGEMONT SD

00050

Hardin County, Ohio  
Michael T. Bacon, Auditor

05-180004.0000  
A04

AGR  
2025

CAMA / Cont: 2

| SHB+ | CONS | TYPE | FACT | SQ-FT | VALUE |   |       |
|------|------|------|------|-------|-------|---|-------|
| 1 B  | F    | M    |      | 992   |       | a | *MAIN |
| 1    | F/C  | A    |      | 84    |       | b | ADDTN |
|      | EFPP | P    |      | 156   | 6240  | c | PORCH |
| 04   | F    | O    |      | 448   | 5380  | d | OTHER |
|      | EFPP | P    |      | 128   | 5120  | e | PORCH |
|      | OFPP | P    |      | 132   | 3960  | f | PORCH |

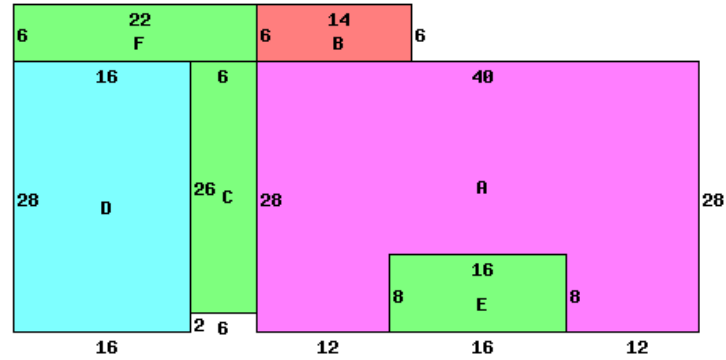

17241 TR 265 43326

| Occupancy 1 Single Family |           | *DWELLING COMPUTATIONS |             |
|---------------------------|-----------|------------------------|-------------|
|                           |           | Sq-Ft                  | Value       |
| Story Height              | 1         |                        |             |
| Floor Level               | Main      | FRAME                  | 1076 103510 |
|                           | Basement  |                        | 992 18500   |
|                           | Subtotal  |                        | 122010      |
| Shingle                   | Roof      | GABLE                  |             |
|                           | B 1 2 U A |                        |             |
| Plaster/Drywall           | D         | Heating                | -1290       |
| Floor/Hardwood            | X         | Plumbing               | -3800       |
| Floor/Pine                | X         | Extra Features         | 20700       |
| Number of Rooms           | 3         | Total Value            | 137620      |
| Bedrooms                  | 2         |                        |             |

| Bldg Type   | SHB+Cons | DixHt | Area | Unit | Grade | Blt/Renov | Replace | Phy | Fnc | True  |
|-------------|----------|-------|------|------|-------|-----------|---------|-----|-----|-------|
| 14 DWELLING | 1 B F    | FtxFt | 1076 | Rate | D     | 1960FR    | 110100  | .47 | .20 | 58350 |

Call Back: - - - - Sign: Date: Lister: 05-180004.0000-v082020R