

BUCK TWP
RIDGEMONT SD

00050

Hardin County, Ohio
Michael T. Bacon, Auditor

05-050011.0000
002

AGR
2023

sale

Eff Rate:- 47.79 — 47.72 — 46.89 — 39.00 — a/r

| | | | | | |
|------|----------------------|------------|----------------|---------|--|
| 2020 | MAST EZRA P & MARY O | 2008-05-01 | | | |
| 2021 | MAST EZRA P & MARY O | 2008-05-01 | | | |
| 2022 | MAST EZRA P & MARY O | 2008-05-01 | | | |
| 2023 | MAST EZRA P & MARY O | 2008-05-01 | 10104 | 55.382A | |
| | 12387 CR 190 | 1SD | | | |
| | | \$108,500 | | | |
| | KENTON OH 43326 | | 12.0-06-05-011 | | |

| | | | | | | | |
|------------|---------|---------|---------|---------|---------|---------|---------|
| Tax Year | 2020 | 2021 | 2022 | 2023 | 2023 | 2024 | CAMA |
| Prop Cls | 111 | 111 | 111 | 111 | 111 | 111 | 111 |
| Acres | 55.3820 | 55.3820 | 55.3820 | 55.3820 | 313310 | 313310 | 313300 |
| Land100% | 286690 | 286690 | 286690 | 313310 | 313310 | 313310 | 313300 |
| Bldg100% | 114430 | 114430 | 114430 | 135940 | 135940 | 243830 | 243820 |
| Totl100% | 401110t | 401110t | 401110t | 449260t | 449260t | 557140t | 557120t |
| Cauv100% | 81570 | 81570 | 81570 | 149910 | 313310 | 313310 | 149920 |
| Tax Value: | | | | | | | |
| Land 35% | 28550 | 28550 | 28550 | 52470 | 52470 | 52470 | 109660 |
| Bldg 35% | 40050 | 40050 | 40050 | 47580 | 47580 | 85340 | 85340 |
| Totl 35% | 68600t | 68600t | 68600t | 100050t | 100050t | 137810t | 194990t |
| Hmstd35% | 30010 | 30010 | 30010 | 33180 | 33180 | 70940 | |
| Owner Oc | 31.70 | 31.68 | 31.14 | 28.98 | hmstd | 6440 l | 26740 b |
| Hmstd RB | | | | | | | |
| Net Tax | 2956.94 | 2952.20 | 2901.12 | 3523.00 | | | |
| Cauv Sav | 3127.64 | 3122.64 | 3068.62 | 2030.36 | | | |
| Sp-Asmnt | 25.28 | 25.28 | 42.08 | 42.08 | | | |

| | | | | | | | |
|------|------|------|------|-------|-------|---|-------|
| SHB+ | CONS | TYPE | FACT | SQ-FT | VALUE | a | *MAIN |
| 1 | F | M | | 900 | | b | PORCH |
| | CAN | P | | 120 | 960 | c | PORCH |
| | CAN | P | | 64 | 510 | d | ADDTN |
| 1 B | F | A | | 40 | | e | PORCH |
| 1 B | OFF | P | | 336 | 10080 | f | ADDTN |
| 2 B | F | A | | 240 | | g | ADDTN |
| | OFF | P | | 1216 | | h | PORCH |
| | | | | 120 | 3600 | | |

| | | | | | | | |
|---------------------------------|-------|------------|----------------------|---------------|--------|---------|---------|
| 2024 N/C ADDITS TO HOUSE | | | | | | | |
| Sale# | #p | sale date | To | Type/Invalid? | Sale\$ | co:land | co:bldg |
| 191 | 1 | 2008-05-01 | MAST EZRA P & MARY O | 1SD * | 108500 | 107860 | 0 |
| Year | Land | Bldg | Total | Net Tax | | | |
| 2019 | 44890 | 35580 | 80470 | 3151.52 | | | |
| 2018 | 44890 | 32150 | 77040 | 2987.96 | | | |
| Project | | | | ben acres | / | % | factor |
| 902 MAIN DISTRICT CONSERVANCY | | | | XA/2023 | | | |
| 500 HARDIN COUNTY LANDFILL | | | | XA/2023 | | | |
| 333 TAYLOR CREEK #1096 - SCIOTO | | | | XA/2023 | | | |

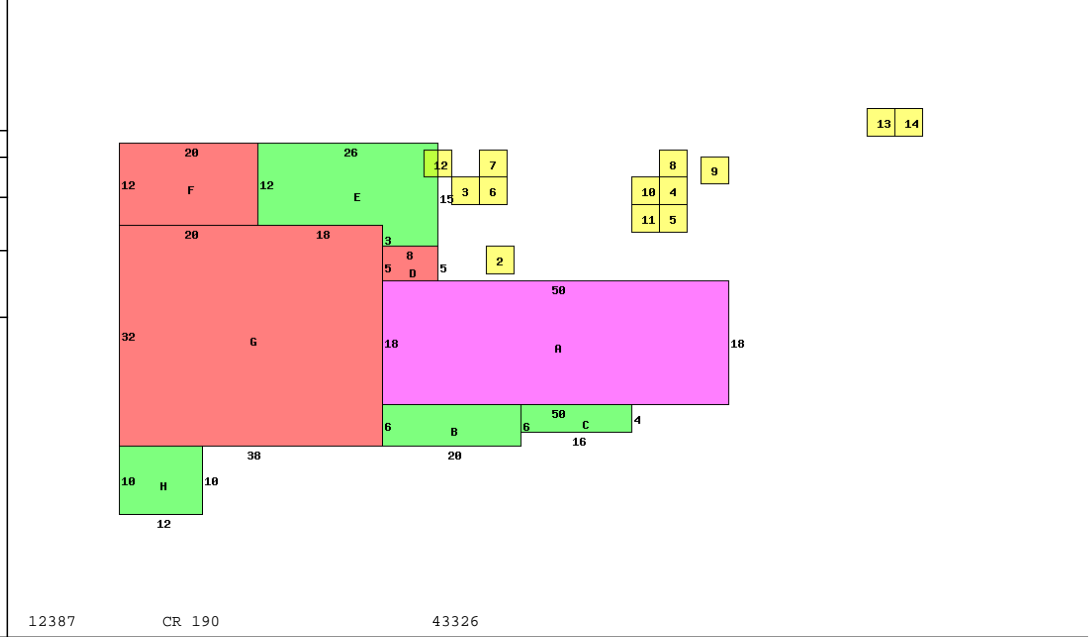

| | | | | |
|-----------------|-----------------|------------------------|--------|-------------|
| Occupancy | 1 Single Family | *DWELLING COMPUTATIONS | Sq-Ft | Value |
| Story Height | 1 | | | |
| Floor Level | | Main | FRAME | 2396 158810 |
| | | Full Upper | FRAME | 1216 62470 |
| | | Basement | | 1496 27680 |
| | | Subtotal | | 248960 |
| Metal | | Roof | GABLE | |
| | | B 1 2 U A | | |
| Plaster/Drywall | X | Heating | | -4280 |
| Number of Rooms | 3 | Plumbing | | -3800 |
| Bedrooms | 1 | Extra Features | | 15150 |
| | | Total Value | | 256030 |
| | | PUB ELECTRIC | | |
| | | PRIV WATER | | |
| | | PRIV SEWER | | |
| | | PUB PAVED ST/RD | | |
| | | Topo: ROLLING | | |
| | | Neighborhood: | | |
| | | Code: | 400 | |
| | | Dwl/Gar/NC% | 1.2500 | |

| | | | | | | |
|-------|---------------------------|---------|--------|--------|--------|-------------|
| 12387 | CR 190 | 43326 | | | | |
| Tab # | S O I L | Acres | Mkt/Ac | Market | Au/Ac | Cauv |
| C 1 | BOA BLOUNT SILT LOAM 0- | 10.3271 | 6030 | 62270 | 2660 | 27470 |
| C 2 | BOB BLOUNT SILT LOAM, 2 | 25.6307 | 5770 | 147890 | 2360 | 60490 |
| C 14 | GWB GLYNWOOD SILT LOAM | .4404 | 5400 | 2380 | 1750 | 770 |
| C 15 | GYB2 GLYNWOOD CLAY LOAM | 1.5693 | 5020 | 7880 | 1230 | 1930 |
| C 39 | PM PEWAMO SILTY CLAY L | 11.4762 | 6490 | 74480 | 3560 | 40860 |
| 680 | HSITE HOMESITE - AMISH DW | 1.0000 | 9200 | 9200 | 9200 | 9200 |
| 980 | ROAD ROAD | 3.9383 | | | | |
| 680 | HSITE HOMESITE - AMISH DW | 1.0000 | 9200 | 9200 | 9200 | 9200 |
| | | 55.382 | | 313300 | (100%) | 149920 |
| | | | | 109660 | (35%) | 52470 |
| | | | | | | CAUV # 3558 |

Call Back: Sign: PSN Date: 2018-06-20 Lister: 05-050011.0000-v082020R
 Call Back: Sign: PSN Date: 2015-08-06 Lister: