

BUCK TWP
RIDGEMONT SD

00050

Hardin County, Ohio
Michael T. Bacon, Auditor

05-012699.9999

RES
2025

sale

2022 BAUM HARLEY RICHARD	2009-01-01
2023 HINKLE CORLISS ELTON	2022-03-08
2024 SARI K SILWANI TRUST	2023-10-19
2025 SARI K SILWANI TRUST	
5330 LAKEVIEW DR	
POWELL OH 43065	\$0

Eff Rate:-	47.72	46.89	39.00	41.37	a/r
Tax Year	2022	2023	2024	2025	
Prop Cls	0	0	0	0	CAMA 570
Acres					
Land100%					
Bldg100%	7830	7830	9570	9570	3350
Totl100%	7830t	7830t	9570t	9570t	3350t
Cauv100%					
Tax Value:					
Land 35%	2740	2740	3350	3350	1170
Bldg 35%	2740t	2740t	3350t	3350t	1170t
Totl 35%					
Hmstd35%					
Owner Oc		1.00			
Hmstd RB		40.04			
Net Tax	41.76		41.56	44.32	

SHB+	CONS	TYPE	FACT	SQ-FT	VALUE	a	OTHER
50	DK	P		792	28560	b	PORCH
				32	480		
Sale#	#p	sale date	To	Type/Invalid?	Sale\$	co:land	co:bdg
27	1	2023-10-19	SARI K SILWANI TRUST	EX *	0	0	0
	1	2023-10-02	RICHARDSON CARL E & KELLY	CO *	0	0	0
10	1	2022-03-08	HINKLE CORLISS ELTON	CF	100	0	0
Year	Land	Bldg	Total	Net Tax			
2021	0	2740	2740	41.82			
2020	0	2740	2740	37.90			

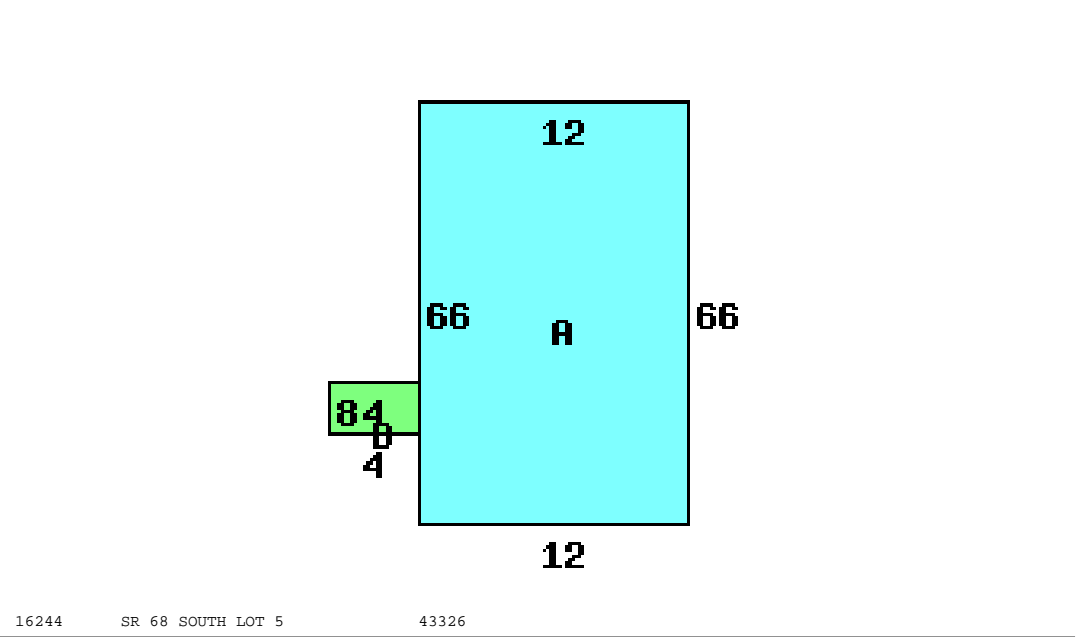

Occupancy 8 M/H	
B 1 2 U A	
Extra Features	29040
Total Value	29040
Neighborhood:	
Code:	9040

Bldg Type	SHB+Cons	DixHt	Unit	Blt/Renov	Replace	Phy	Fnc	True
1 MH/LRE	1 F/C	12X56	0	E+	1991AV	17420	.65	.45
								3350

Call Back: Sign: JLR Date: 2009-01-01 Lister: 05-012699.9999-v082020R