

BUCK TWP
KENTON SD

00040

Hardin County, Ohio
Michael T. Bacon, Auditor

04-110018.0000
Q04

EXM
2025

sale

Eff Rate:- 56.33 — 52.87 — 55.36 — 55.06 — a/r

| | | | | | |
|------|--------------------------|-------|-------|--------|-----|
| 2022 | HARDIN CO COMMISSIONE | | | | |
| 2023 | HARDIN CO COMMISSIONE | | | | |
| 2024 | HARDIN CO COMMISSIONE | | | | |
| 2025 | HARDIN CO COMMISSIONERS | | | | |
| | 14134 & 14176 LETSON AVE | 10040 | 10292 | 45.41A | |
| | KENTON OH 43326 | | | | \$0 |

| | | | | | |
|------------|----------|----------|----------|----------|----------|
| Tax Year | 2022 | 2023 | 2024 | 2025 | CAMA |
| Prop Cls | 620 | 620 | 620 | 620 | 620 |
| Acres | 45.4100 | 45.4100 | 45.4100 | 45.4100 | |
| Land100% | 415290 | 415290 | 415290 | 415290 | 415280 |
| Bldg100% | 1107910 | 1147940 | 1147940 | 1147940 | 1147950 |
| Totl100% | 1523200t | 1563230t | 1563230t | 1563230t | 1563230t |
| Cauv100% | | | | | |
| Tax Value: | | | | | |
| Land 35% | 145350 | 145350 | 145350 | 145350 | 145350 |
| Bldg 35% | 387770 | 401780 | 401780 | 401780 | 401780 |
| Totl 35% | 533120t | 547130t | 547130t | 547130t | 547130t |
| Hmstd35% | | | | | |
| Owner Oc | | | | | |
| Hmstd RB | | | | | |
| Net Tax | | | | | |
| Sp-Asmnt | 319.34 | 67.04 | 191.50 | 151.38 | |

| | | | | | | | |
|-------------------------------|--------|--------|--------|-----------|-------|--------|-------|
| SHB+ | CONS | TYPE | FACT | SQ-FT | VALUE | a | *MAIN |
| 1 B | F | M | | 1200 | | b | PORCH |
| | DK | P | | 90 | 1350 | c | PORCH |
| | DK | P | | 32 | 480 | | |
| Year | Land | Bldg | Total | Net Tax | | | |
| 2021 | 145350 | 387770 | 533120 | 0.00 | | | |
| 2020 | 145350 | 387770 | 533120 | 0.00 | | | |
| Project | | | | ben acres | / % | factor | |
| 902 MAIN DISTRICT CONSERVANCY | | | | XA/2025 | | | |

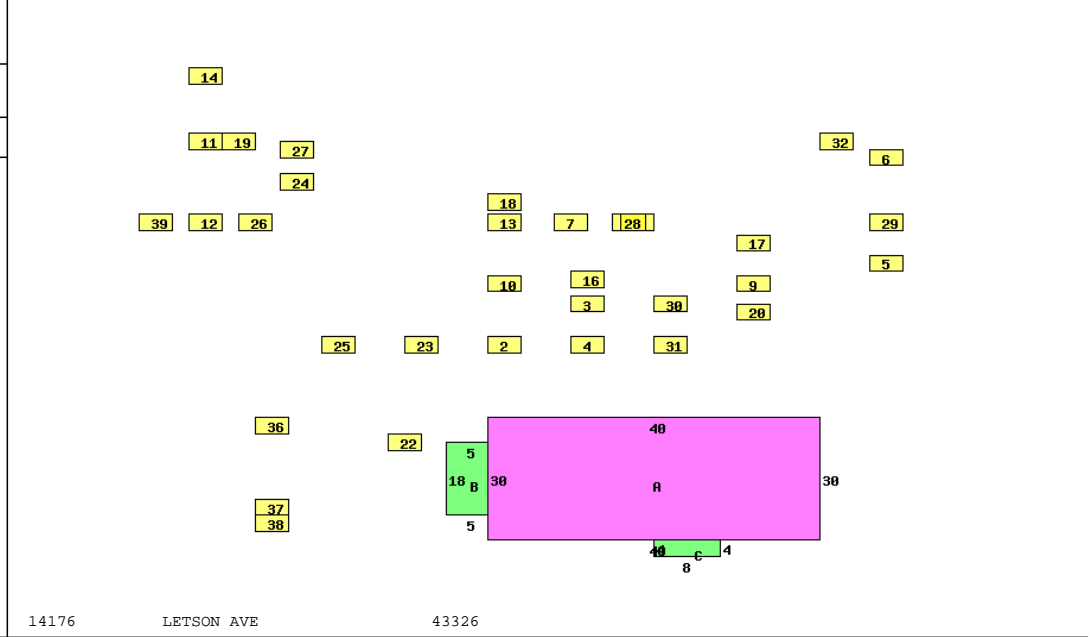

| | | | | |
|-----------------|-----------------|------------------------|-------|--------|
| Occupancy | 1 Single Family | *DWELLING COMPUTATIONS | Sq-Ft | Value |
| Story Height | 1 | | | |
| Floor Level | Main | FRAME | 1200 | 106310 |
| | Basement | | 1200 | 22360 |
| | Subtotal | | | 128670 |
| Shingle | Roof | GABLE | | |
| | B 1 2 U A | | | |
| Plaster/Drywall | X | Plumbing | | 700 |
| Unfinished Wall | X | Extra Features | | 1830 |
| Floor/Hardwood | X | Total Value | | 131200 |
| Number of Rooms | 1 5 | | | |
| Bedrooms | 2 | PUB PAVED ST/RD | | |
| Central Heat | A | Neighborhood: | | |
| FORCED AIR | | Code: | | 400 |
| Plumbing | | Dwl/Gar/NC% | | 1.2500 |
| Standard | 1 | | | |
| Extra Fixture | 1 | | | |

| | | | | | | | | | | |
|---------------|----------|----------|-------|-------|--------|-----------|---------|-----|-----|--------|
| Bldg Type | SHB+Cons | DixHt | Area | Unit | Grade | Blt/Renov | Replace | Phy | Fnc | True |
| 1 DWELLING | 1 B F | 1200 | | | C- | 1930AV | 118080 | .55 | Dpr | 53140 |
| 2 TICKET OF | | 310 | 24.00 | C | 1950AV | 7440 | .80 | | | 1490 |
| 3 MERCH BLD | | 10808 | 13.20 | C | 1930AV | 142670 | .80 | | | 28530 |
| 4 RESTROOM | | 30X30 | 900 | 50.00 | C | 2008AV | 45000 | .20 | | 36000 |
| 5 HORSE BAR | | | 8080 | 13.20 | C | 1930AV | 106660 | .80 | | 21330 |
| 6 HORSE BAR | | | 9951 | 13.20 | C | 1930AV | 131350 | .80 | | 26270 |
| 7 GRANDSTAN | | 1 160X65 | 10400 | 57.00 | C | 1960AV | 592800 | .80 | | 118560 |
| 8 ARTS-CRAF | | 1 100X72 | 7200 | 13.20 | C | 1960AV | 95040 | .80 | | 19010 |
| 9 COMMBLDG | | 1 150X70 | 10500 | 65.04 | C | 1994AV | 682920 | .40 | | 409750 |
| 10 JR FAIR | | | 22698 | 13.20 | C | 1930AV | 299610 | .80 | | 59920 |
| 11 DAIRYBARN | | | 50602 | 13.20 | C | 1930AV | 667950 | .80 | | 133590 |
| 12 Poultry Ho | | 31X53 | 1643 | 13.20 | C | 1930AV | 21690 | .80 | | 4340 |
| 13 TRACK | *NV | | 0 | | | OLD/ | 0 | | | 0 |
| 14 HORSEBARN | | | 9146 | 13.20 | C | 1930AV | 120730 | .80 | | 24150 |
| 15 FENCE 6' | | | 5000 | 13.50 | C | 1960AV | 67500 | .80 | | 13500 |
| 16 Gazebo | | | 140 | 22.00 | C | 1980AV | 3080 | .80 | | 620 |
| 17 Shed | | 13X20 | 260 | 12.00 | C | 1930AV | 3120 | .80 | | 620 |
| 18 Shed | | 12X20 | 240 | 12.00 | C | 1990AV | 2880 | .80 | | 580 |
| 19 CANOPY | | 50X52 | 2600 | 8.00 | C | 1930AV | 20800 | .80 | | 4160 |
| 20 SHELTER | | 50X80 | 4000 | 12.00 | C | 1980AV | 48000 | .80 | | 9600 |
| 21 Paving | | | 50000 | 1.50 | C | 1960AV | 75000 | .80 | | 15000 |
| 22 Garage | | 20X22 | 440 | 24.00 | C | 1930AV | 10560 | .80 | | 2110 |
| 23 SHERRIF | *PP | 20X50 | 1000 | | | 1999AV | 0 | | | 0 |
| 24 RESTROOM | | 24X36 | 864 | 50.00 | C | 1980AV | 43200 | .55 | | 19440 |
| 25 Pole Build | | 32X40 | 1280 | 10.12 | C | 2009AV | 12950 | .35 | | 8420 |
| 26 RESTROOM | | 30X36 | 1080 | 50.00 | C | 2006AV | 54000 | .30 | | 37800 |
| 27 SHELTER | | 48X48 | 2304 | 12.00 | C | 1980AV | 27650 | .80 | | 5530 |
| 28 Shed | *NV | 10X12 | 120 | | | 1930AV | 0 | | | 0 |
| 29 CANOPY | | 31X70 | 2170 | 15.00 | C | 1994AV | 32550 | .70 | | 9770 |
| 30 OFFICE | | 20X33 | 660 | 65.30 | C | 1960AV | 43100 | .75 | | 10780 |
| 35 FENCE 4' | | | 1000 | 8.40 | C | 1930AV | 8400 | .80 | | 1680 |
| 36 Pole Build | | 50X50 | 2500 | 12.01 | C | 2012AV | 30030 | .20 | | 24020 |
| 37 SHERIFF | | 30X60 | 1800 | 7.92 | C | 2012AV | 14260 | .20 | | 11410 |
| 38 P | CAN | 8X20 | 160 | 7.00 | C | 2012AV | 1120 | .20 | | 900 |