

BLANCHARD TWP  
DUNKIRK CORP

00030

Hardin County, Ohio  
Michael T. Bacon, Auditor

03-100049.0000  
B53

RES  
2025

sale

Eff Rate:- 49.09 — 39.07 — 39.36 — 39.22 — a/r

2022 GUGLIELMI NAN HOLLING	1999-10-07
2023 GUGLIELMI NAN HOLLING	1999-10-07
2024 GUGLIELMI NAN HOLLING	1999-10-07
2025 GUGLIELMI NAN HOLLINGTO	1999-10-07 PACKERS E 30
120 S WALNUT ST	2WD
DUNKIRK OH 45836	\$40,000

Tax Year	2022	2023	2024	2025	2025	CAMA
Prop Cls	510	510	510	510	510	510
Acres						
Land100%	4170	5110	5110	5110	5110	5100
Bldg100%	51200	89030	89030	89030	89030	89030
Totl100%	55370t	94140t	94140t	94140t	94140t	94130t
Cauv100%						
Tax Value:						
Land 35%	1460	1790	1790	1790	1790	1790
Bldg 35%	17920	31160	31160	31160	31160	31160
Totl 35%	19380t	32950t	32950t	32950t	32950t	32950t
Hmstd35%						
Owner Oc						
Hmstd RB						
Net Tax	861.28	1165.06	1175.28	1170.68	1170.68	
Sp-Asmnt	21.00	25.00	21.00	21.00		

SHB+	CONS	TYPE	FACT	SQ-FT	VALUE	a	*MAIN
2 B	B	M		1376			
	OMP	P		239	8370	b	PORCH
	OMP	P		64	2240	c	PORCH
	OMP	P		64	2240	d	PORCH

Sale#	#p	sale date	To	Type/Invalid?	Sale\$	co:land	co:blgd
605	2	1999-10-07	GUGLIELMI NAN HOLLINGTON	2WD	40000	3970	7940

Year	Land	Bldg	Total	Net Tax
2021	1460	17920	19380	865.72
2020	1460	17920	19380	869.24

project	ben acres	%	factor
305 LEASE #1037 - BLANCHARD			XA/2025
500 HARDIN COUNTY LANDFILL			XA/2025
921 BLANCHARD RIVER MAINT			XA/2023

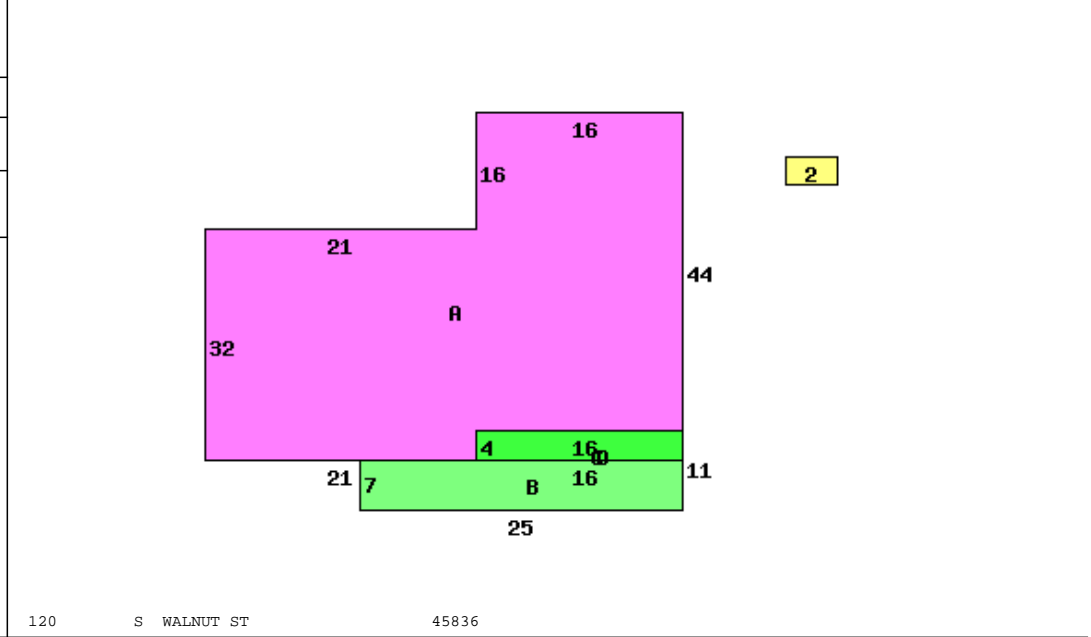

Occupancy 1 Single Family	*DWELLING COMPUTATIONS	
Story Height 2	Sq-Ft	Value
Floor Level		
Main	BRICK	1376 120410
Full Upper	BRICK	1376 72210
Basement		1376 25470
Subtotal		218090
Metal Roof	MANSARD	
Plaster/Drywall	X X	Extra Features 12850
Unfinished Wall	X	Total Value 230940
Floor/Hardwood	X X	
Number of Rooms	1 5 4	PUB SIDEWALK
Bedrooms	2 4	
Central Heat	A	Neighborhood: 310
FUEL OIL		Code: .8500
Plumbing		Dwl/Gar/NC%
Standard	1	

Bldg Type	SHB+Cons	DixHt	Unit	Blt/Renov	Replace	Phy Dpr	Fnc Dpr	True Value
1 DWELLING	1 B B	2752		C	OLD/AV	230940	.55	88340
2 Flat Barn		24X30	720	D	OLD/FR	6910	.80 .50	690
front lot	acres/ frontage	effective frontage	depth	actual factor	effective rate	extended value	true value	
	60.00	132	94	90	85	5100	5100	