

BLANCHARD TWP
DUNKIRK CORP

00030

Hardin County, Ohio
Michael T. Bacon, Auditor

03-010021.0000
E95

RES
2025

sale

Eff Rate:- 49.09 — 39.07 — 39.36 — 39.22 — a/r

2022 WHITE KASH & ISABEL	2016-12-20
2023 WHITE KASH & ISABEL	2016-12-20
2024 WHITE KASH & ISABEL	2016-12-20
2025 WHITE KASH & ISABEL	2016-12-20 MILLERS 5TH 6
150 S BUCKEYE ST	1SD
DUNKIRK OH 45836	\$46,500

Tax Year	2022	2023	2024	2025	CAMA
Prop Cls	510	510	510	510	510
Acres	4030	4970	4970	4970	4980
Land100%	36910	41830	41830	41830	41840
Bldg100%	40940t	46800t	46800t	46800t	46820t
Totl100%					
Cauv100%					
Tax Value:					
Land 35%	1410	1740	1740	1740	1740
Bldg 35%	12920	14640	14640	14640	14640
Totl 35%	14330t	16380t	16380t	16380t	16390t
Hmstd35%					
Owner Oc					
Hmstd RB					
Net Tax	636.84	579.18	584.24	581.98	
Sp-Asmnt	21.00	25.00	21.00	24.00	

SHB+	CONS	TYPE	FACT	SQ-FT	VALUE	a	*MAIN
1	F/C	M		1220			
	EFP	P		98	3920	b	PORCH
	DK	P		144	2160	c	PORCH
	F/C	A		21		d	ADDTN

Sale#	#p	sale date	To	Type/Invalid?	Sale\$	co:land	co:bldg
574	1	2016-12-20	WHITE KASH & ISABEL	1SD	46500	3940	32260
66	1	2007-02-15	MOORE JACOB B	1WD *	46000	4090	32140
261	0	1988-04-11			0	0	18110

Year	Land	Bldg	Total	Net Tax
2021	1410	12920	14330	640.12
2020	1410	12920	14330	642.72

p r o j e c t		ben acres	/ %	factor
235 KELLOGG #983 - BLANCHARD	XA/2025			
921 BLANCHARD RIVER MAINT	XA/2023			
500 HARDIN COUNTY LANDFILL	XA/2025			
305 LEASE #1037 - BLANCHARD	XA/2025			

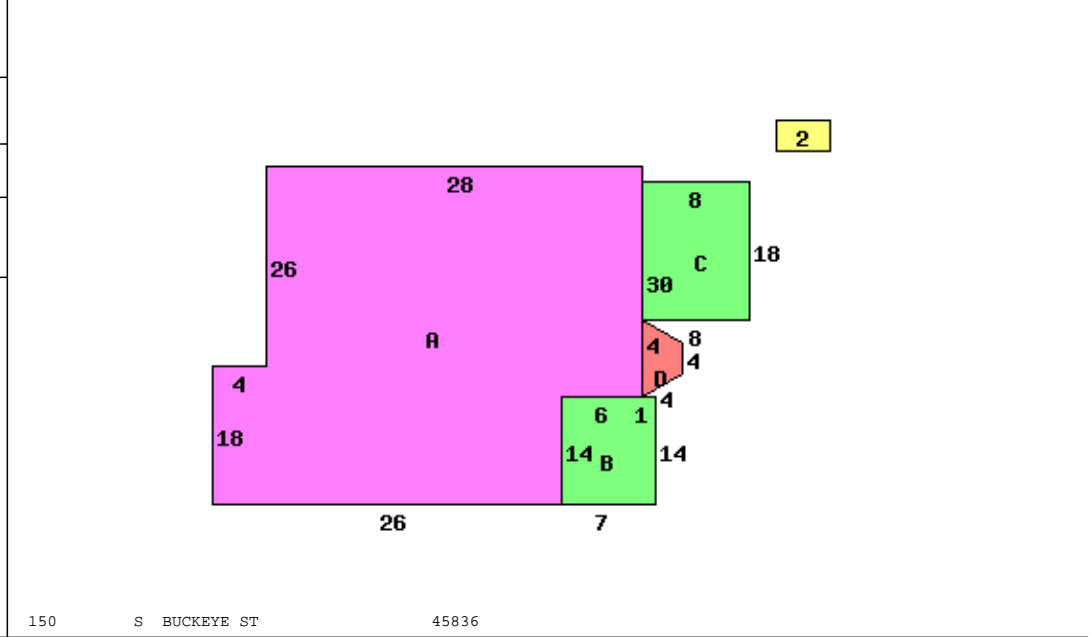

150 S BUCKEYE ST 45836

Occupancy 1 Single Family	*DWELLING COMPUTATIONS	
Story Height 1	Sq-Ft	Value
Floor Level	1241	106250
Shingle	Main Subtotal	106250
	Roof	
Panelled Wall	X	Air Conditioning 2220
Floor/Carpet	X	Extra Features 6080
Number of Rooms	7	Total Value 114550
Bedrooms	2	
Central Heat	A	PUB SIDEWALK
SPACE HEAT		Neighborhood:
Central A/C	A	Code: 310
Plumbing		Dwl/Gar/NC% .8500
Standard	1	

Bldg Type	SHB+Cons	DixHt	Unit	Blt/Renov	Replace	Phy	Fnc	True
1 DWELLING	1 F/C							
2 Garage		14X24	336	C	OLD/AV	.55		39440
				C	OLD/AV	.65		2400
front lot	acres/ frontage	effective frontage	depth	actual factor	effective rate	extended value	true value	
	60.00	128	92	90	83	4980	4980	