

BLANCHARD TWP
RIVERDALE SD

00020

Hardin County, Ohio
Michael T. Bacon, Auditor

02-080017.0000
H11

RES
2025

sale

Eff Rate:- 37.34 — 32.22 — 32.62 — 32.56 — a/r

2022 DODGE GARY W & CHARLO	1993-08-03
2023 DODGE GARY W & CHARLO	1993-08-03
2024 DODGE GARY W & CHARLO	1993-08-03
2025 DODGE TEIA L & SCOTT M	2024-06-21 PT NW1/4 NW1/4 S10 2.00A
15530 CR 20	1WD
FOREST OH 45843	\$291,500

Tax Year	2022	2023	2024	2025	CAMA
Prop Cls	511	511	511	511	511
Acres	2.0000	2.0000	2.0000	2.0000	20000
Land100%	15600	20000	20000	20000	150710
Bldg100%	133630	150710t	150710t	150710t	170710t
Totl100%	149230t	170710t	170710t	170710t	
Cauv100%					
Tax Value:					
Land 35%	5460	7000	7000	7000	7000
Bldg 35%	46770	52750	52750	52750	52750
Totl 35%	52230t	59750t	59750t	59750t	59750t
Hmstd35%	51180	58000	58000	58000	
Owner Oc	45.08	44.38	44.34	44.26	hmstd 5250 l 52750 b
Hmstd RB					
Net Tax	1721.10	1698.10	1721.88	1718.82	
Sp-Asmnt	26.65	30.65	29.54	29.54	

SHB+ 1 Q	CONS F/C	TYPE M	FACT	SQ-FT 1400	VALUE 13820	a *MAIN
	F2	G		576	720	b GRAGE
	OP	P		24		c PORCH
	DK	P		240	3600	d PORCH

Sale#	#p	sale date	To	Type/Invalid?	Sale\$	co:land	co:bldg
248	1	2024-06-21	DODGE TEIA L & SCOTT M	1WD	291500	20000	150710
701	1	1993-08-03	DODGE GARY W & CHARLOTTE	1WD	115000	0	89710
186	2	1989-03-10		2WD	6000	2000	0

Year	Land	Bldg	Total	Net Tax
2021	5460	46770	52230	1880.10
2020	5460	46770	52230	1884.76

p r o j e c t		ben acres	/ %	factor
169	KEIPER JOINT - BLANCHARD			XA/2025
497	KEIPER JT DITCH - HANCOCK CO			XA/2015
921	BLANCHARD RIVER MAINT			XA/2023
500	HARDIN COUNTY LANDFILL			XA/2025

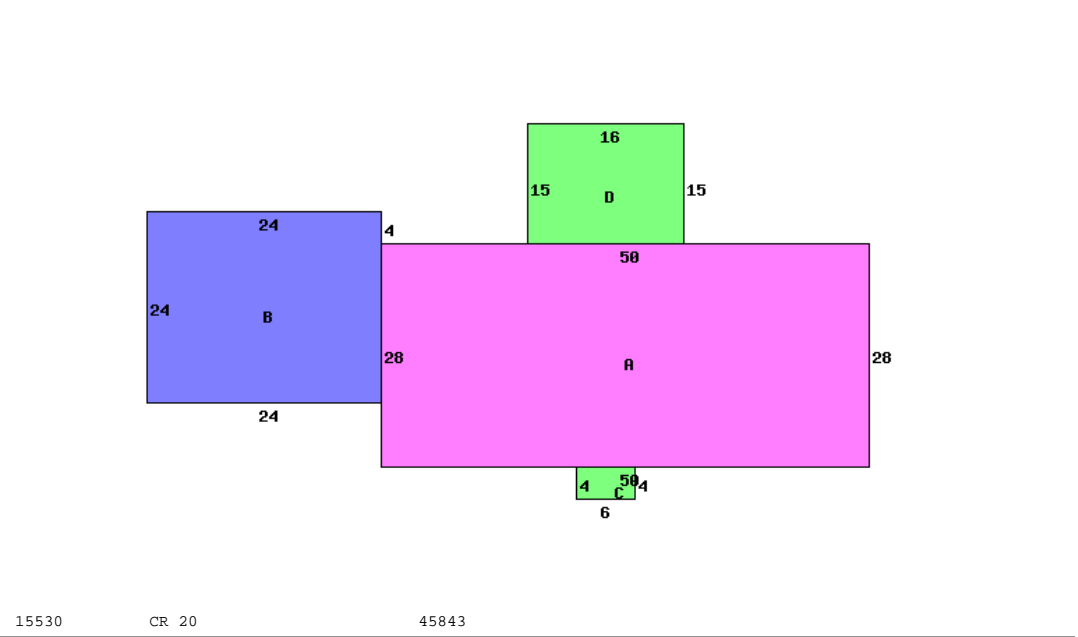

Occupancy 1 Single Family				*DWELLING COMPUTATIONS	
Story Height	1Q		Sq-Ft	Value	
Floor Level	Main	FRAME	1400	111360	
	Qtr Story	FRAME	1400	20760	
	Subtotal			132120	
Shingle	Roof	GABLE			
B 1 2 U A					
Plaster/Drywall	X	X	Air Conditioning	4880	
Floor/Pine	X	X	Plumbing	3500	
Floor/Carpet	X	X	Garages and Carports	13820	
Number of Rooms	5	2	Extra Features	4320	
Bedrooms	1	2	Total Value	158640	
Central Heat	A				
FORCED AIR			Neighborhood:		
Central A/C	A		Code:	100	
Plumbing			Dwl/Gar/NC%	1.2500	
Standard	1				
Extra 3 Fixture	1				
Extra 2 Fixture	1				

Bldg Type	SHB+Cons	DixHt	Unit	Blt/Renov	Replace	Phy Fnc	True
1 DWELLING	1 QF/C	FtxFt	Area	Grade	Cond	Dpr Dpr	Value
		1400		C	1989GD	.24	150710
homesite	1.0000	effective	depth	actual	effective	extended	true
small acreage	1.0000	frontage	depth	rate	rate	value	value
			factor	15000	15000	15000	15000
				5000	5000	5000	5000

Call Back:

Sign: PSN Date: 2015-10-20 Lister:

02-080017.0000-v082020R